

HSK - G01  
DRAWING NO.

天水圍 TIN SHUI WAI  
元朗 YUEN LONG  
屯門 TUEN MUN

HSK-G01  
HSK-G02  
HSK-G03

位置圖  
LOCATION PLAN

不按比例  
NOT TO SCALE

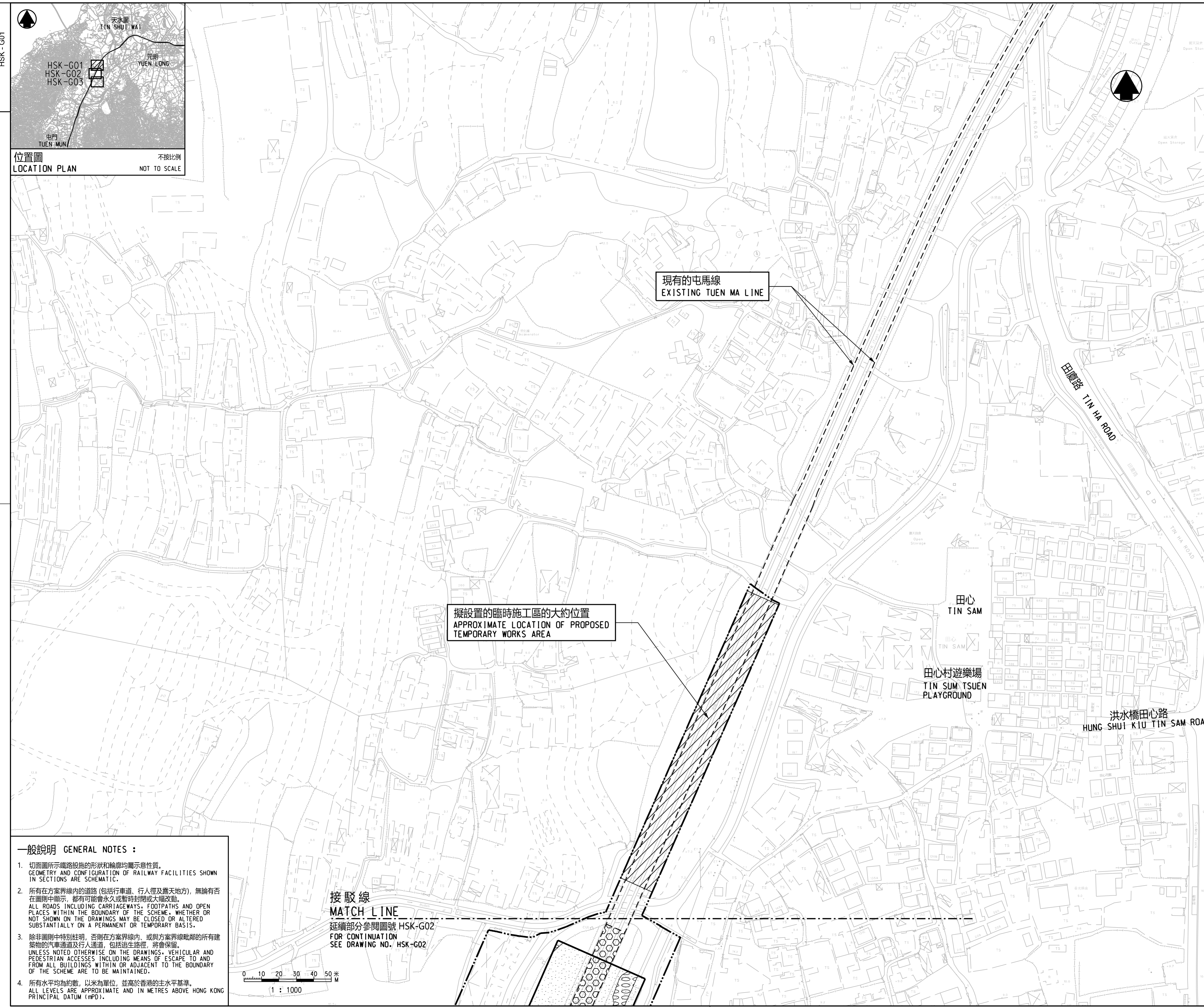

圖例 LEGEND :

- 方案界線  
BOUNDARY OF THE SCHEME
- 擬建的鐵路車站 / 車站入口 / 其他鐵路設施或永久建築物  
PROPOSED RAILWAY STATION / STATION ENTRANCES / OTHER RAILWAY FACILITIES OR PERMANENT STRUCTURES
- 現有的鐵路設施  
EXISTING RAILWAY FACILITIES
- 擬設置地盤設施的臨時施工區  
PROPOSED TEMPORARY WORKS AREA FOR SITE FACILITIES
- 擬進行修改工程的現有屯馬線  
PROPOSED MODIFICATION WORKS OF THE EXISTING TUEN MA LINE
- 可能永久封閉的道路 (包括行車道、行人徑及露天地方)  
ROADS (INCLUDING CARRIAGEWAYS, FOOTPATHS AND OPEN PLACE) WHICH MAY BE CLOSED PERMANENTLY

修訂表  
TABLE OF AMENDMENTS

修改 REV	日期 DATE	繪圖 BY	核對 SUB	負責 APP	說明 DESCRIPTION

SIGNED  
溫健雄 WAN KIN HUNG, DENNIS  
路政署  
鐵路拓展處處長 (2)  
GOVERNMENT ENGINEER/  
RAILWAY DEVELOPMENT (2)  
HIGHWAYS DEPARTMENT

07 FEB 2023  
發出日期 DATE OF ISSUE

圖則名稱 DRAWING TITLE  
鐵路條例 (第519章)  
位於洪水橋的鐵路車站  
總體規劃圖則 3頁的第1頁

RAILWAYS ORDINANCE (CHAPTER 519)  
RAILWAY STATION AT HUNG SHUI KIU  
GENERAL LAYOUT PLAN SHEET 1 OF 3

圖號 DRAWING NO.  
HSK - G01

比例 SCALE  
1:1000 (A1)  
或如圖示  
AS SHOWN

香港特別行政區政府  
THE GOVERNMENT OF THE HONG KONG  
SPECIAL ADMINISTRATIVE REGION

路政署  
HIGHWAYS DEPARTMENT

鐵路拓展處  
RAILWAY DEVELOPMENT OFFICE

一般說明 GENERAL NOTES :

- 切面圖所示鐵路設施的形狀和輪廓均屬示意性質。  
GEOMETRY AND CONFIGURATION OF RAILWAY FACILITIES SHOWN IN SECTIONS ARE SCHEMATIC.
- 所有在方案界線內的道路 (包括行車道、行人徑及露天地方), 無論有否在圖則中顯示, 都有可能永久或暫時封閉或大幅改動。  
ALL ROADS INCLUDING CARRIAGEWAYS, FOOTPATHS AND OPEN PLACES WITHIN THE BOUNDARY OF THE SCHEME, WHETHER OR NOT SHOWN ON THE DRAWINGS MAY BE CLOSED OR ALTERED SUBSTANTIALLY ON A PERMANENT OR TEMPORARY BASIS.
- 除非圖則中特別註明, 否則在方案界線內、或與方案界線毗鄰的所有建築物的汽車通道及行人通道, 包括逃生路徑, 將會保留。  
UNLESS NOTED OTHERWISE ON THE DRAWINGS, VEHICULAR AND PEDESTRIAN ACCESSES INCLUDING MEANS OF ESCAPE TO AND FROM ALL BUILDINGS WITHIN OR ADJACENT TO THE BOUNDARY OF THE SCHEME ARE TO BE MAINTAINED.
- 所有水平均為約數, 以米為單位, 並高於香港的主水平基準。  
ALL LEVELS ARE APPROXIMATE AND IN METRES ABOVE HONG KONG PRINCIPAL DATUM (mPD).

