

一般說明 GENERAL NOTES

- 有關一般說明參閱圖號 KTE - G01。
FOR GENERAL NOTES, REFER TO DRAWING NO. KTE-G01.
- 收回的地層在圖則第KTE-U01至KTE-U03號中以參線的切面立視圖顯示。
UNDERGROUND STRATA TO BE RESUMED ARE SHOWN IN THE SECTIONAL ELEVATION ALONG THE REFERENCE LINE IN DRAWING NO. KTE-U01 TO KTE-U03.
- 沿參線的切面立視圖顯示的正/負主水平基準均為約數。
THE +/- mPDs SHOWN IN THE SECTIONAL ELEVATION ALONG REFERENCE LINE ARE APPROXIMATE.
- 圖則顯示於可被收回的地層內的任何現有公用設施將不會被收回。
ANY EXISTING UTILITIES LOCATED WITHIN THE UNDERGROUND STRATA PROPOSED TO BE RESUMED WILL NOT BE RESUMED.

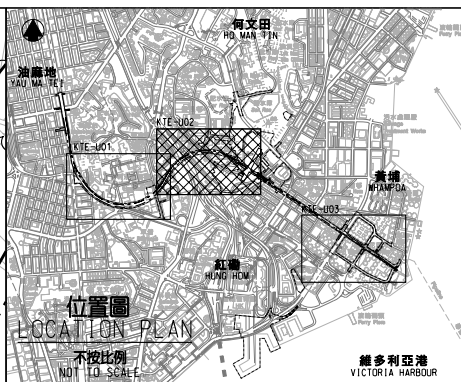
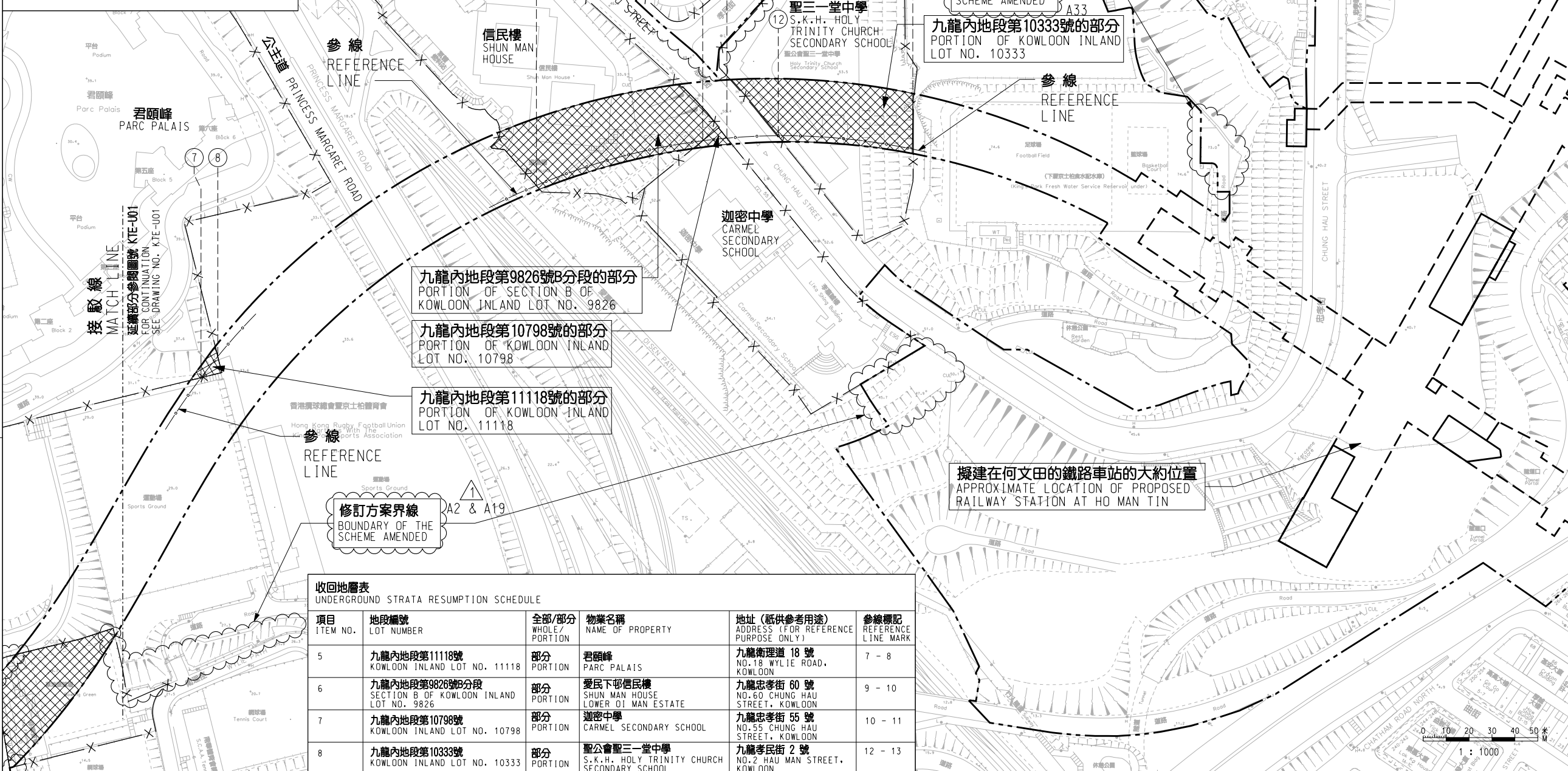

圖例 LEGEND

- 方案界線
BOUNDARY OF THE SCHEME
- 可被收回的地層
UNDERGROUND STRATA PROPOSED TO BE RESUMED
- 擬建的鐵路車站及其他鐵路設施
PROPOSED RAILWAY STATION AND OTHER RAILWAY FACILITIES
- 擬建的鐵路車站及其他鐵路設施(地下)
PROPOSED RAILWAY STATION AND OTHER RAILWAY FACILITIES (UNDERGROUND)
- 地段界線
LOT BOUNDARY
- 參線標記
REFERENCE LINE MARK
- 參線
REFERENCE LINE
- 資料已更改
INFORMATION CHANGED
- 收回地層表的新增地段
ADDITIONAL LOT IN UNDERGROUND STRATA RESUMPTION SCHEDULE
- 圖則修改
DRAWING REVISION
- 修訂參考編號(參考憲報公告)
AMENDMENT REFERENCE NUMBER (SEE GAZETTE NOTICE)
- 修訂範圍
AMENDMENT AREA

收回地層表 UNDERGROUND STRATA RESUMPTION SCHEDULE

項目 ITEM NO.	地段編號 LOT NUMBER	全部/部分 WHOLE/ PORTION	物業名稱 NAME OF PROPERTY	地址(祇供參考用途) ADDRESS (FOR REFERENCE PURPOSE ONLY)	參線標記 REFERENCE LINE MARK
5	九龍內地段第11118號 KOWLOON INLAND LOT NO. 11118	部分 PORTION	君頤峰 PARC PALAIS	九龍衛理道 18 號 NO.18 WYLIE ROAD, KOWLOON	7 - 8
6	九龍內地段第9826號B分段 SECTION B OF KOWLOON INLAND LOT NO. 9826	部分 PORTION	愛民下邨信民樓 LOWER OI MAN ESTATE SHUN MAN HOUSE	九龍忠孝街 60 號 NO.60 CHUNG HAU STREET, KOWLOON	9 - 10
7	九龍內地段第10798號 KOWLOON INLAND LOT NO. 10798	部分 PORTION	迦密中學 CARMEL SECONDARY SCHOOL	九龍忠孝街 55 號 NO.55 CHUNG HAU STREET, KOWLOON	10 - 11
8	九龍內地段第10333號 KOWLOON INLAND LOT NO. 10333	部分 PORTION	聖公會聖三一堂中學 S.K.H. HOLY TRINITY CHURCH SECONDARY SCHOOL	九龍孝民街 2 號 NO.2 HAU MAN STREET, KOWLOON	12 - 13

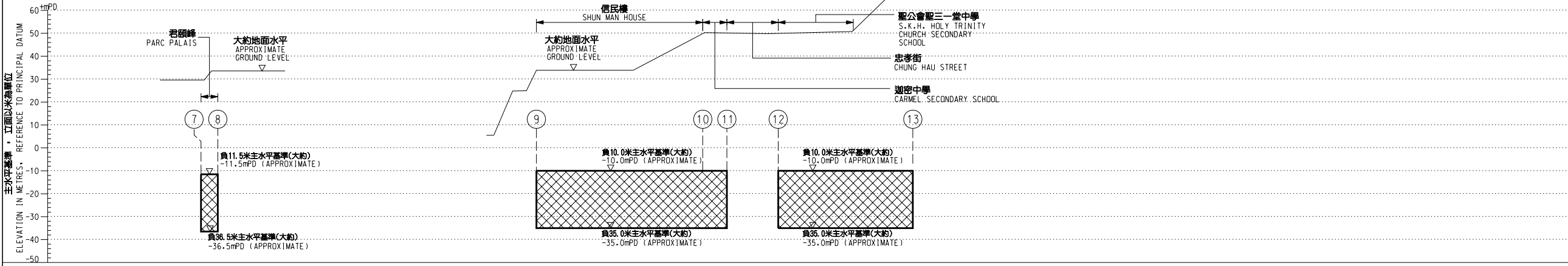

修訂表 TABLE OF AMENDMENTS

修訂日期 REV DATE	日期 DATE	繪圖 BY	核對 SUB	負責 APP	說明 DESCRIPTION
09 JUN 2010	MKC	CH	PP		修訂項目 A2, A19, A32 及 A33 AMENDMENT ITEMS A2, A19, A32 AND A33 修訂位置圖 LOCATION PLAN AMENDED

SIGNED

陳志恩 CHAN CHI YAN, HENRY
路政署
鐵路拓展處處副處長(1)
GOVERNMENT ENGINEER/
RAILWAY DEVELOPMENT (1)
HIGHWAYS DEPARTMENT

11 JUN 2010
發出日期 DATE OF ISSUE

圖則名稱 DRAWING TITLE
**鐵路條例(第519章)
- 觀塘線延伸
收回地層圖則 3頁的第2頁**

RAILWAYS ORDINANCE (CHAPTER 519)
- KWUN TONG LINE EXTENSION

UNDERGROUND STRATA RESUMPTION PLAN
SHEET 2 OF 3

圖號 DRAWING NO. KTE-U02

比例 SCALE 1:1000 (A1)
或如顯示
AS SHOWN

香港特別行政區政府
THE GOVERNMENT OF THE HONG KONG
SPECIAL ADMINISTRATIVE REGION

路政署
HIGHWAYS DEPARTMENT

鐵路拓展處
RAILWAY DEVELOPMENT OFFICE

沿參線的切面立視圖 SECTIONAL ELEVATION ALONG REFERENCE LINE

