

DRAWING NO. SCL-T01

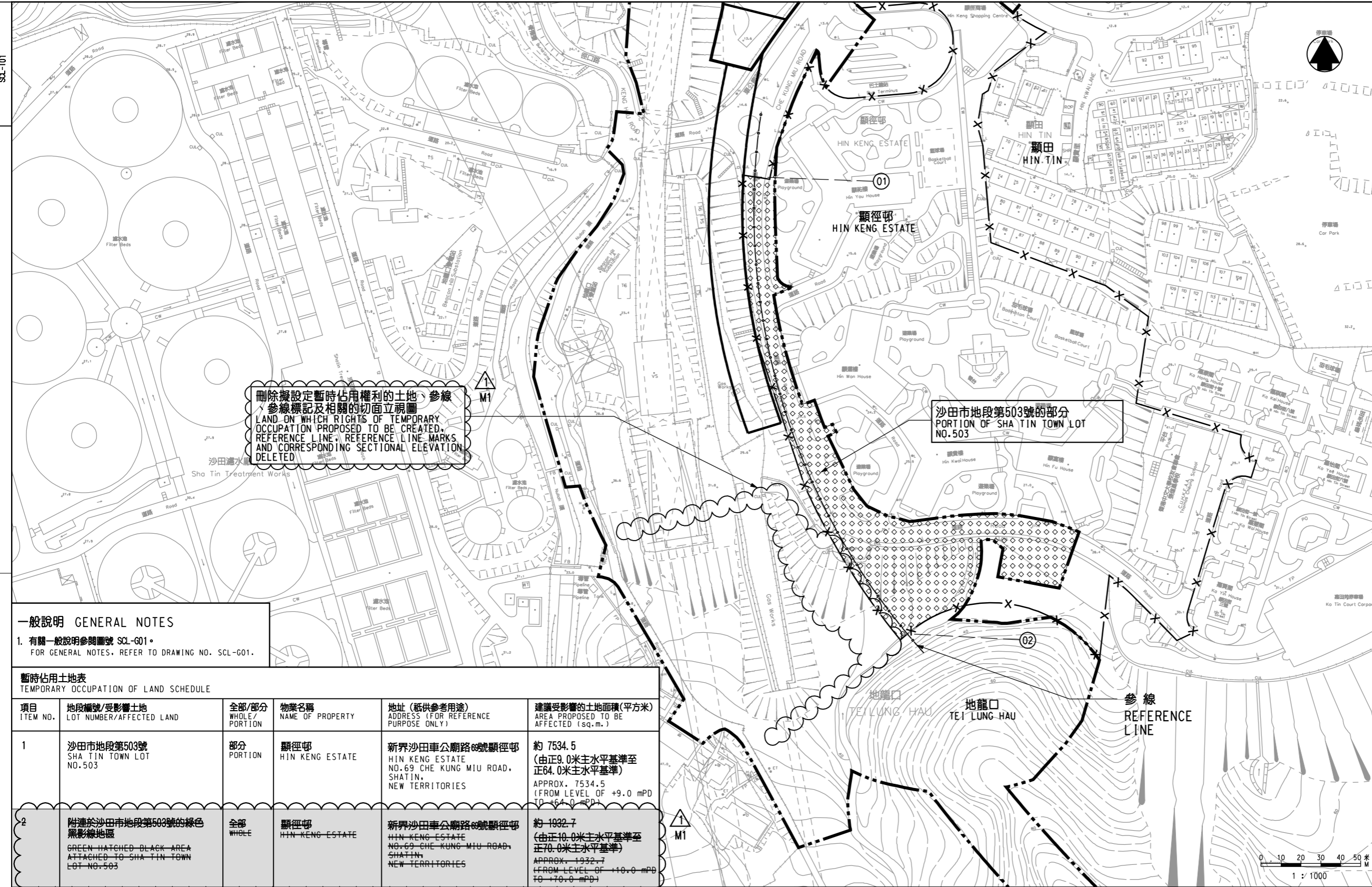

刪除擬設定暫時佔用權利的土地、參線、參線標記及相關的切面立視圖  
 LAND ON WHICH RIGHTS OF TEMPORARY OCCUPATION PROPOSED TO BE CREATED, REFERENCE LINE, REFERENCE LINE MARKS AND CORRESPONDING SECTIONAL ELEVATION DELETED

沙田市地段第503號的部分  
 PORTION OF SHA TIN TOWN LOT NO. 503

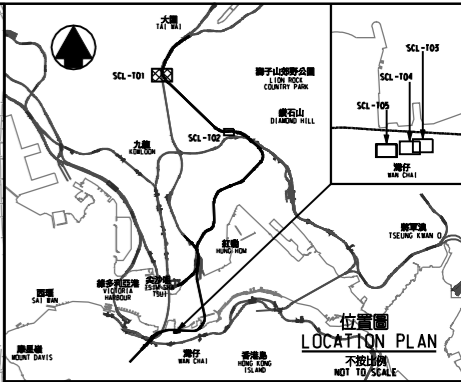

- 圖例 LEGEND**
- 方案界線  
BOUNDARY OF THE SCHEME
  - X- 地段界線  
LOT BOUNDARY
  - 受影響綠色黑影線地區界線  
BOUNDARY OF AFFECTED GREEN HATCHED BLACK AREA
  - ② 參線標記  
REFERENCE LINE MARK
  - 參線  
REFERENCE LINE
  - 擬建的鐵路車站及其他鐵路設施(地下)  
PROPOSED RAILWAY STATION AND OTHER RAILWAY FACILITIES (UNDERGROUND)
  - 擬建的車站/車站入口/通風大樓/通風井/其他鐵路設施或永久建築物  
PROPOSED RAILWAY STATION/STATION ENTRANCES/VENTILATION BUILDINGS/VENTILATION SHAFTS/OTHER RAILWAY FACILITIES OR PERMANENT STRUCTURES
  - 建議將予設定暫時佔用權利的土地  
LAND ON WHICH RIGHTS OF TEMPORARY OCCUPATION IS PROPOSED TO BE CREATED
  - 無須設定暫時佔用土地權利的土地  
LAND EXCLUDED FROM CREATION OF RIGHTS OF TEMPORARY OCCUPATION
  - △ 刪則修改  
DRAWING REVISION
  - M1 修改參考編號(參考憲報公告)  
MODIFICATION REFERENCE NUMBER (SEE GAZETTE NOTICE)
  - 修改範圍  
MODIFICATION AREA

**一般說明 GENERAL NOTES**  
 1. 有關一般說明參閱圖號 SCL-G01。  
 FOR GENERAL NOTES, REFER TO DRAWING NO. SCL-G01.

| 暫時佔用土地表<br>TEMPORARY OCCUPATION OF LAND SCHEDULE |  |                            |                          |  |   |
|--|--|----------------------------|--------------------------|--|---|
| 項目<br>ITEM NO.                                   | 地段編號/受影響土地<br>LOT NUMBER/AFFECTED LAND   | 全部/部分<br>WHOLE/<br>PORTION | 物業名稱<br>NAME OF PROPERTY | 地址(紙供參考用途)<br>ADDRESS (FOR REFERENCE<br>PURPOSE ONLY)  | 建議受影響的土地面積(平方米)<br>AREA PROPOSED TO BE<br>AFFECTED (sq.m.)  |
| 1  | 沙田市地段第503號<br>SHA TIN TOWN LOT NO. 503   | 部分<br>PORTION              | 顯徑邨<br>HIN KENG ESTATE   | 新界沙田車公廟路69號顯徑邨<br>HIN KENG ESTATE<br>NO. 69 CHE KUNG MIU ROAD,<br>SHATIN,<br>NEW TERRITORIES | 約 7534.5<br>(由正9.0米主水平基準至<br>正64.0米主水平基準)<br>APPROX. 7534.5<br>(FROM LEVEL OF +9.0 mPD<br>TO +64.0 mPD)   |
| 2  | 附連於沙田市地段第503號的綠色<br>黑影線地區<br>GREEN HATCHED BLACK AREA<br>ATTACHED TO SHA TIN TOWN<br>LOT NO. 503 | 全部<br>WHOLE                | 顯徑邨<br>HIN KENG ESTATE   | 新界沙田車公廟路69號顯徑邨<br>HIN KENG ESTATE<br>NO. 69 CHE KUNG MIU ROAD,<br>SHATIN,<br>NEW TERRITORIES | 約 1932.7<br>(由正10.0米主水平基準至<br>正70.0米主水平基準)<br>APPROX. 1932.7<br>(FROM LEVEL OF +10.0 mPD<br>TO +70.0 mPD) |

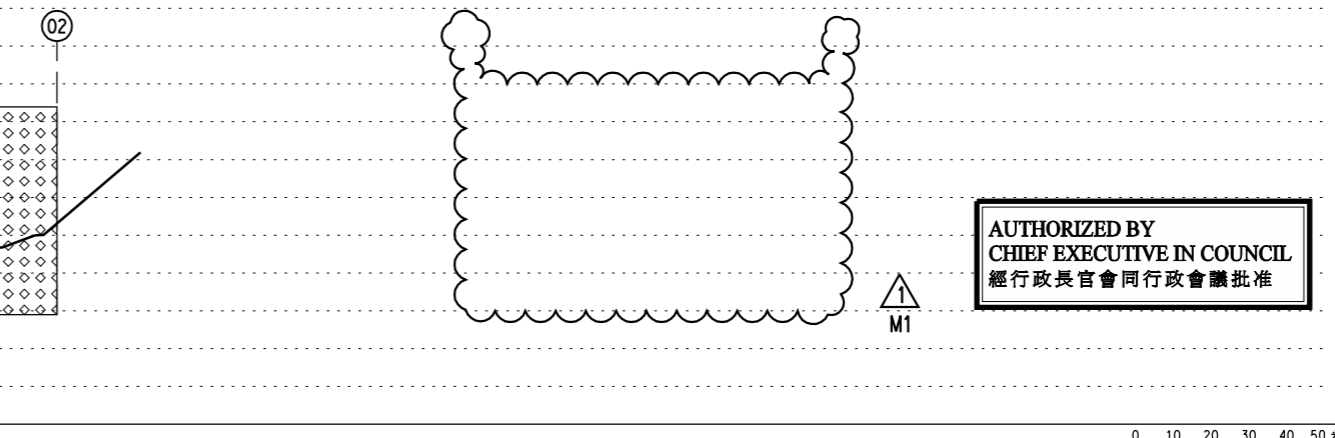
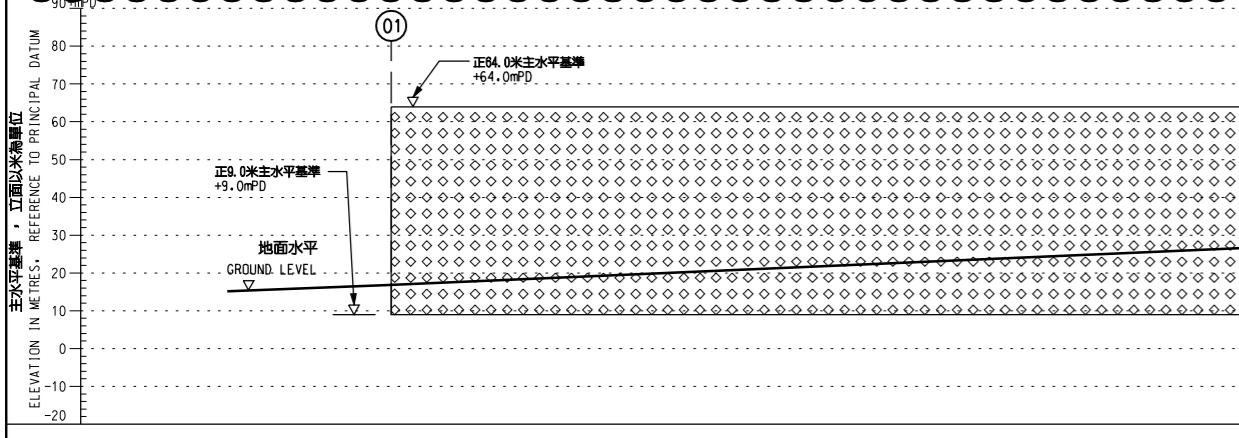

AUTHORIZED BY  
 CHIEF EXECUTIVE IN COUNCIL  
 經行政長官會同行政會議批准

修訂表  
TABLE OF AMENDMENTS

| 修訂<br>REV  | 日期<br>DATE | 由<br>BY | 類別<br>SUB | 說明<br>APP                     | 說明<br>DESCRIPTION |
|------------|------------|---------|-----------|-------------------------------|-------------------|
| 5 MAR 2012 | CADD       | KCF     | DN        | 修改項目 1<br>MODIFICATION ITEM 1 |                   |

SIGNED  
 馮傑榮 ERIC K W FUNG  
 路政署  
 鐵路拓展處處長(1)  
 GOVERNMENT ENGINEER/  
 RAILWAY DEVELOPMENT (1)  
 HIGHWAYS DEPARTMENT

28.3.2012  
 發出日期 DATE OF ISSUE

圖則名稱 DRAWING TITLE  
**鐵路條例(第519章)  
 沙田至中環線  
 設定暫時佔用土地權利圖則  
 5頁的第1頁**  
 RAILWAYS ORDINANCE (CHAPTER 519)  
 SHATIN TO CENTRAL LINK  
 CREATION OF TEMPORARY  
 OCCUPATION OF LAND PLAN SHEET 1 OF 5

圖號 DRAWING NO. SCL-T01 比例 SCALE 1:1000 (A1) 或如顯示 AS SHOWN

香港特別行政區政府  
 THE GOVERNMENT OF THE HONG KONG  
 SPECIAL ADMINISTRATIVE REGION  
**路政署**  
 HIGHWAYS DEPARTMENT  
**鐵路拓展處**  
 RAILWAY DEVELOPMENT OFFICE

沿參線的切面立視圖 SECTIONAL ELEVATION ALONG REFERENCE LINE

