

DRAWING NO. SCL-G13

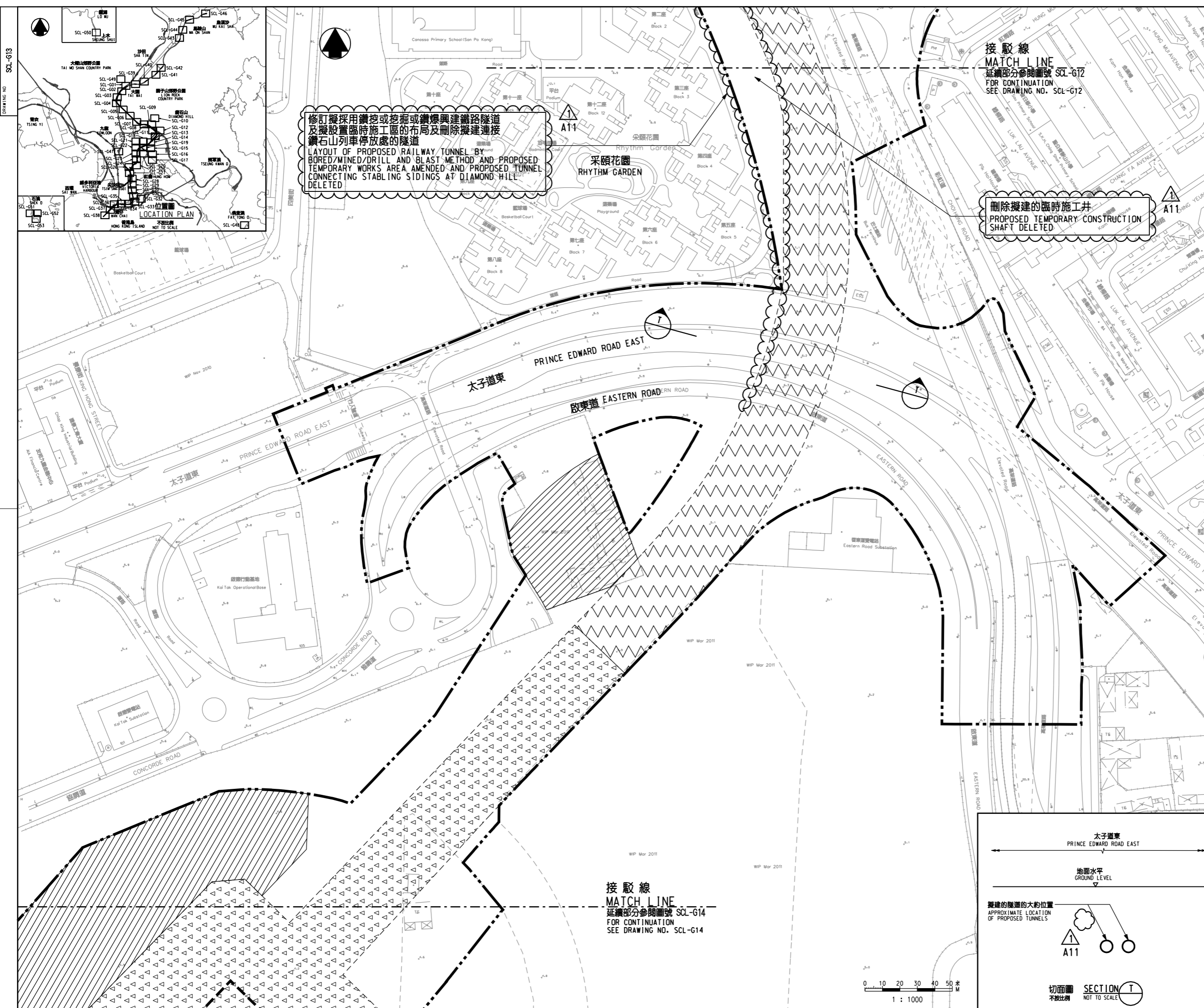

修訂擬採用鑽挖或挖掘或鑽爆興建鐵路隧道及擬設置臨時施工區的布局及刪除擬建連接鑽石山列車停放處的隧道
 LAYOUT OF PROPOSED RAILWAY TUNNEL BY BORED/MINED/DRILL AND BLAST METHOD AND PROPOSED TEMPORARY WORKS AREA AMENDED AND PROPOSED TUNNEL CONNECTING STABLING SIDINGS AT DIAMOND HILL DELETED

接駁線
 MATCH LINE
 延續部分參閱圖號 SCL-G12
 FOR CONTINUATION
 SEE DRAWING NO. SCL-G12

刪除擬建的臨時施工井
 PROPOSED TEMPORARY CONSTRUCTION SHAFT DELETED

接駁線
 MATCH LINE
 延續部分參閱圖號 SCL-G14
 FOR CONTINUATION
 SEE DRAWING NO. SCL-G14

- 圖例 LEGEND**
- 方案界線
BOUNDARY OF THE SCHEME
 - 擬建的鐵路車站及其他鐵路設施(地下)
PROPOSED RAILWAY STATION AND OTHER RAILWAY FACILITIES (UNDERGROUND)
 - 擬建的車站/車站入口/通風大樓/通風井
其他鐵路設施永久建築物
PROPOSED RAILWAY STATION/STATION ENTRANCES/VENTILATION BUILDINGS/VENTILATION SHAFTS/OTHER RAILWAY FACILITIES OR PERMANENT STRUCTURES
 - 現有的車站及其他鐵路設施
EXISTING STATION AND OTHER RAILWAY FACILITIES
 - 擬採用鑽挖或挖掘或鑽爆的鐵路設施或隧道(地下)
PROPOSED RAILWAY FACILITIES/TUNNEL BY BORED/MINED/DRILL AND BLAST METHOD (UNDERGROUND)
 - 擬採用明挖法興建的鐵路設施或隧道(地下)
PROPOSED RAILWAY FACILITIES/TUNNEL BY CUT-AND-COVER METHOD (UNDERGROUND)
 - 可能永久封閉的道路(包括行車道、行人徑及露天地方) WHICH MAY BE CLOSED PERMANENTLY
 - 擬設置地盤設施的臨時施工區
PROPOSED TEMPORARY WORKS AREA FOR SITE FACILITIES
 - 擬於政府前濱或海床設置地盤設施的臨時施工區
(可能在其上進行填海工程(非為形成土地)或其他工程)
PROPOSED TEMPORARY WORKS AREA FOR SITE FACILITIES ON GOVERNMENT FORESHORE OR SEABED (COVER OR UPON WHICH RECLAMATION NOT FOR THE PURPOSE OF FORMING LAND) OR OTHER WORKS MAY BE CARRIED OUT
 - 擬建的行人天橋/扶手電梯/升降機/樓梯
PROPOSED FOOTBRIDGE/ESCALATOR/LIFT/STAIRCASE
 - ☆☆☆☆ 擬建的有蓋行人通道
PROPOSED COVERED WALKWAY
 - 擬於政府前濱或海床採用明挖法興建的鐵路設施或隧道
(可能在其上進行填海工程(非為形成土地)或其他工程)
PROPOSED RAILWAY FACILITIES/TUNNEL BY CUT-AND-COVER METHOD ON GOVERNMENT FORESHORE OR SEABED (COVER OR UPON WHICH TEMPORARY RECLAMATION (FOR THE PURPOSE OF FORMING TEMPORARY LAND) OR OTHER WORKS MAY BE CARRIED OUT)
 - 擬於政府前濱或海床採用沉管法興建的鐵路設施或隧道(包括保護層/覆面岩石)
(可能在其上進行填海工程(非為形成土地)或其他工程)
PROPOSED RAILWAY FACILITIES/TUNNEL (INCLUDING PROTECTION LAYER/ROCK ARMOUR) BY IMMERSED TUBE METHOD ON GOVERNMENT FORESHORE OR SEABED (COVER OR UPON WHICH RECLAMATION (NOT FOR THE PURPOSE OF FORMING LAND) OR OTHER WORKS MAY BE CARRIED OUT)
 - 擬建於保護結構的鐵路設施/隧道(地下)
PROPOSED RAILWAY FACILITIES/TUNNELS (UNDERGROUND) AT PROTECTION STRUCTURES
 - 擬建於沙田至中環線及另一項正在規劃的鐵路項目(下稱「另一項鐵路項目」)使用的隧道(地下)車站/車站大樓/車站入口/通風大樓/通風井/其他鐵路設施或永久建築物(下稱「設施」)及擬建的布爾巴利鐵路另一項鐵路項目方案內
PROPOSED RAILWAY TUNNEL (UNDERGROUND)/RAILWAY STATION/STATION CONCOURSE/STATION ENTRANCES/VENTILATION BUILDINGS/VENTILATION SHAFT/OTHER RAILWAY FACILITIES OR PERMANENT STRUCTURES (HEREAFTER REFERRED TO AS "THE FACILITIES") FOR SHATIN TO CENTRAL LINK AND ANOTHER RAILWAY PROJECT UNDER PLANNING (HEREAFTER REFERRED TO AS "ANOTHER RAILWAY PROJECT"). THE LAYOUT OF THE FACILITIES IS GAZETTED UNDER ANOTHER RAILWAY PROJECT
 - 受影響的政府前濱或海床的大約範圍
APPROXIMATE EXTENT OF AFFECTED GOVERNMENT FORESHORE OR SEABED
 - ▲ 圖則修改
DRAWING REVISION
 - A1 修訂參考編號(參考圖則公告)
AMENDMENT REFERENCE NUMBER (SEE GAZETTE NOTICE)
 - 修訂範圍
AMENDMENT AREA

一般說明 GENERAL NOTES
 1. 有關一般說明參閱圖號 SCL-G01.
 FOR GENERAL NOTES, REFER TO DRAWING NO. SCL-G01.

修訂表
TABLE OF AMENDMENTS

修訂日期	修訂日期	修訂日期	修訂日期	修訂日期	修訂日期	修訂日期	修訂日期	修訂日期	修訂日期
REV	DATE	BY	SUB	APP	REV	DATE	BY	SUB	APP

簽名
SIGNED

馬傑榮 ERIC K W FUNG	路政署 鐵路拓展處處長(1) GOVERNMENT ENGINEER/ RAILWAY DEVELOPMENT (1) HIGHWAYS DEPARTMENT
-------------------	---

批准發出
APPROVED FOR ISSUE

25 OCT 2011
發出日期 DATE OF ISSUE

圖則名稱 DRAWING TITLE
鐵路條例(第519章)
沙田至中環線
 總體規劃圖則 53頁的第13頁

RAILWAYS ORDINANCE (CHAPTER 519)
 SHATIN TO CENTRAL LINK
 GENERAL LAYOUT PLAN SHEET 13 OF 53

圖號 DRAWING NO. SCL-G13 比例 SCALE 1:1000 (A1) 或如顯示 OR AS SHOWN

香港特別行政區政府
 THE GOVERNMENT OF THE HONG KONG
 SPECIAL ADMINISTRATIVE REGION
 路政署
 HIGHWAYS DEPARTMENT
 鐵路拓展處
 RAILWAY DEVELOPMENT OFFICE

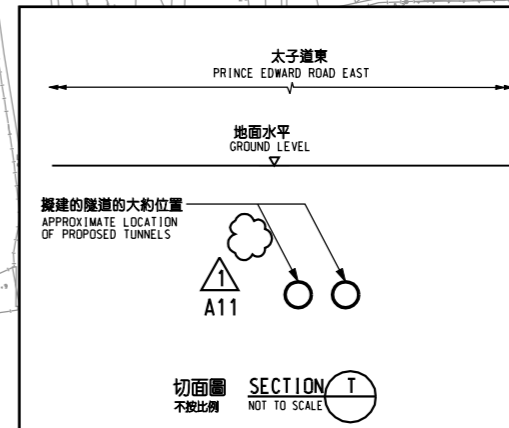

0 10 20 30 40 50 米
 1 : 1000