

- 圖例 LEGEND**
- 方案界線
BOUNDARY OF THE SCHEME
 - 擬建的車站及其他鐵路設施
PROPOSED STATION AND OTHER RAILWAY FACILITIES
 - 擬建的車站及其他鐵路設施(地下)
PROPOSED STATION AND OTHER RAILWAY FACILITIES (UNDERGROUND)
 - 擬採用鑽挖或掘鑽或鑽孔的鐵路設施或隧道(地下)
PROPOSED RAILWAY FACILITIES/TUNNEL BY BORED / MINED / DRILL AND BLAST METHOD (UNDERGROUND)
 - 擬採用明挖回填法興建的鐵路設施或隧道(地下)
PROPOSED RAILWAY FACILITIES/TUNNEL BY CUT-AND-COVER METHOD (UNDERGROUND)
 - 可能永久封閉的道路(包括行車道和行人徑)
ROADS (INCLUDING CARRIAGEWAY AND FOOTPATH) WHICH MAY BE CLOSED PERMANENTLY
 - 擬建的鐵路高架橋
PROPOSED RAILWAY VIADUCT
 - 現有的行人天橋將受影響
EXISTING FOOTBRIDGE TO BE AFFECTED
 - 擬建的臨時行人天橋/地面行人過路處
PROPOSED TEMPORARY FOOTBRIDGE / AT-GRADE PEDESTRIAN CROSSING
 - 擬建的行人天橋
PROPOSED FOOTBRIDGE
 - 可能在其上進行填海工程或其他工程的政府前濱或海床
GOVERNMENT FORESHORE OR SEABED OVER OR UPON WHICH RECLAMATION OR OTHER WORKS MAY BE CARRIED OUT
 - 現有的車站及其他鐵路設施
EXISTING STATION AND OTHER RAILWAY FACILITIES
 - 擬建的臨時架空輸送帶系統
PROPOSED TEMPORARY OVERHEAD CONVEYANCE SYSTEM
 - 擬建的鐵路隧道入口
PROPOSED RAILWAY TUNNEL APPROACH
 - 以主水平基準為依據之擬建路軌大約水平(米)
PROPOSED APPROXIMATE TRACK LEVEL IN m P.D.

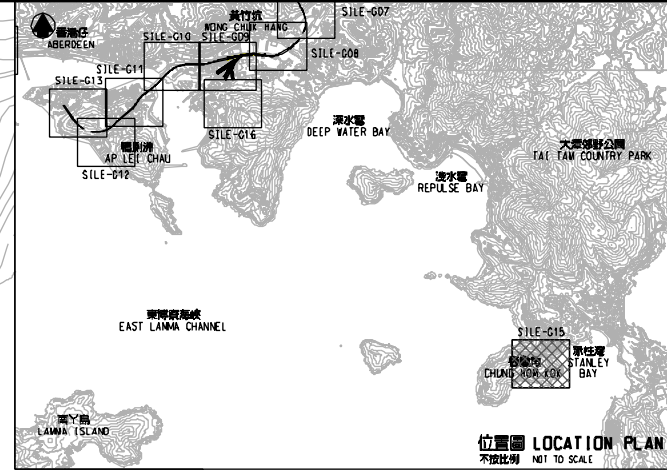
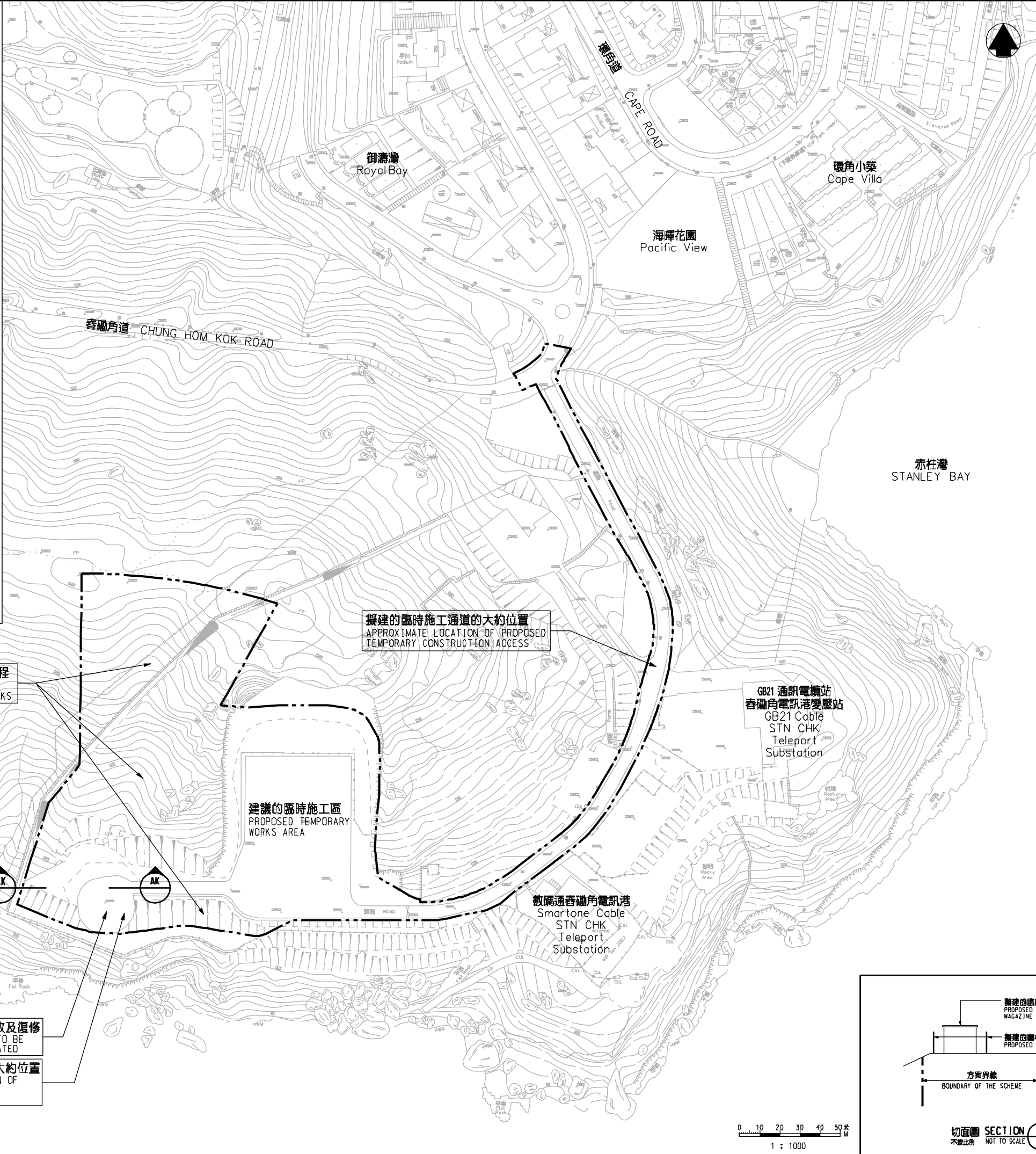

建議的斜坡加固工程
PROPOSED SLOPE STABILIZATION WORKS

擬建的臨時施工通道的大約位置
APPROXIMATE LOCATION OF PROPOSED TEMPORARY CONSTRUCTION ACCESS

建議的臨時施工區
PROPOSED TEMPORARY WORKS AREA

GB21 通訊電纜站
春繩角電訊變壓站
GB21 Cable STN CHK Teleport Substation

數碼通春繩角電訊港
Smartone Cable STN CHK Teleport Substation

現有的構造物將會修改及復修
EXISTING STRUCTURE TO BE MODIFIED AND REINSTATED

擬建的臨時炸藥庫的大約位置
APPROXIMATE LOCATION OF PROPOSED TEMPORARY MAGAZINE SITE

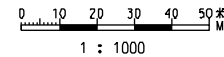
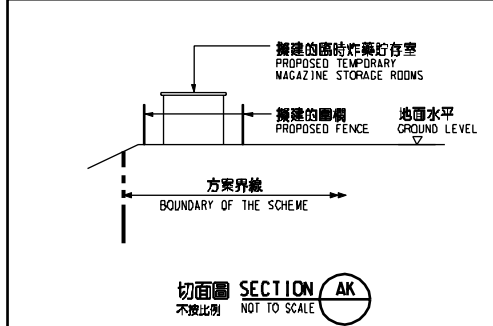

一般說明 GENERAL NOTES
1. 有關一般說明參閱圖號 SILE - G01.
FOR GENERAL NOTES, REFER TO DRAWING NO. SILE - G01.

修訂表
TABLE OF AMENDMENTS

修訂號	日期	修訂人	修訂內容	說明	
REV	DATE	BY	SUB	APP	DESCRIPTION

核准發出
APPROVED FOR ISSUE

何繼宏 HO MAI FU
鐵路發展處處長(2)
GOVERNMENT ENGINEER (2)
RAILWAY DEVELOPMENT (2)
HIGHWAYS DEPARTMENT

發出日期 DATE OF ISSUE

圖則名稱 DRAWING TITLE
南港島線(東段)
鐵路條例(第519章)
總體規劃圖則 16頁的第15頁
SOUTH ISLAND LINE (EAST)
RAILWAYS ORDINANCE (CHAPTER 519)
GENERAL LAYOUT PLAN SHEET 15 OF 16

圖號 DRAWING NO. SILE-G15
比例 SCALE 1:1000 (A1)
或如顯示 AS SHOWN

香港特別行政區政府
THE GOVERNMENT OF THE HONG KONG
SPECIAL ADMINISTRATIVE REGION

路政署
HIGHWAYS DEPARTMENT

鐵路拓展處
RAILWAY DEVELOPMENT OFFICE