

擬建在金鐘的鐵路車站的大約位置
APPROXIMATE LOCATION OF PROPOSED RAILWAY STATION AT ADMIRALTY

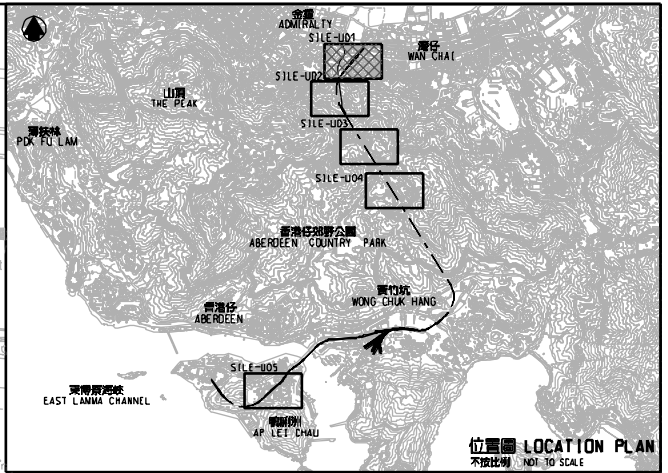

- 一般說明 GENERAL NOTES
- 有關一般說明參考圖號 SILE-G01. FOR GENERAL NOTES, REFER TO DRAWING NO. SILE-G01.
 - 收回地層的細節在圖則第SILE-U06號顯示. DETAILS OF UNDERGROUND STRATA RESUMPTION ARE SHOWN IN DRAWING NO. SILE-U06.
 - 沿參線的切面立視圖顯示的±/負主水平基準均為約數. THE ±/ mPDs SHOWN IN THE SECTIONAL ELEVATION ALONG REFERENCE LINE ARE APPROXIMATE.

- 圖例 LEGEND
- 方案界線 BOUNDARY OF THE SCHEME
 - 地段界線 LOT BOUNDARY
 - 參線 REFERENCE LINE
 - 參線標記 REFERENCE LINE MARK
 - 建議收回的地層 UNDERGROUND STRATA PROPOSED TO BE RESUMED
 - 擬建的車站及其他鐵路設施(地下) PROPOSED STATION AND OTHER RAILWAY FACILITIES (UNDERGROUND)

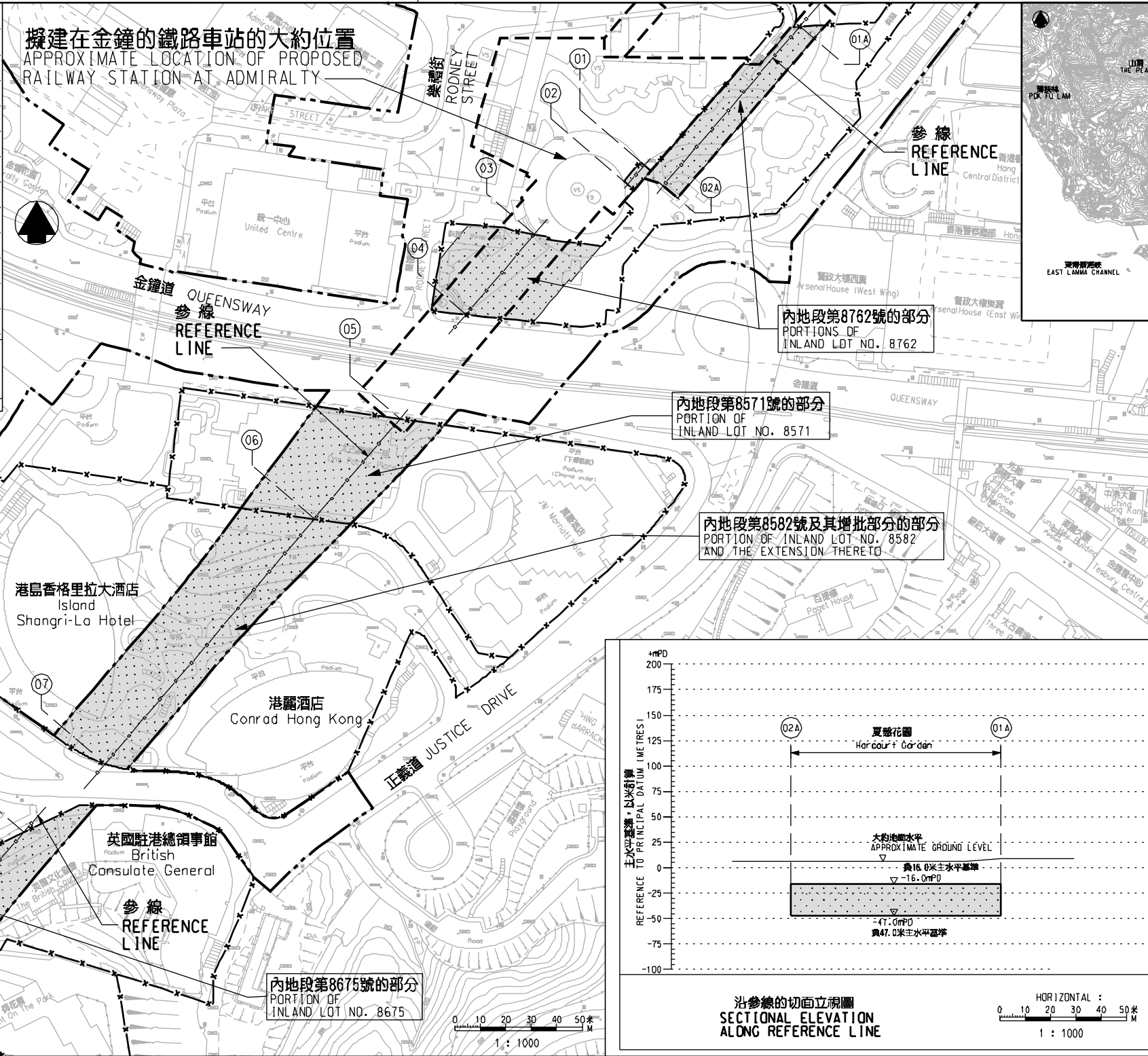
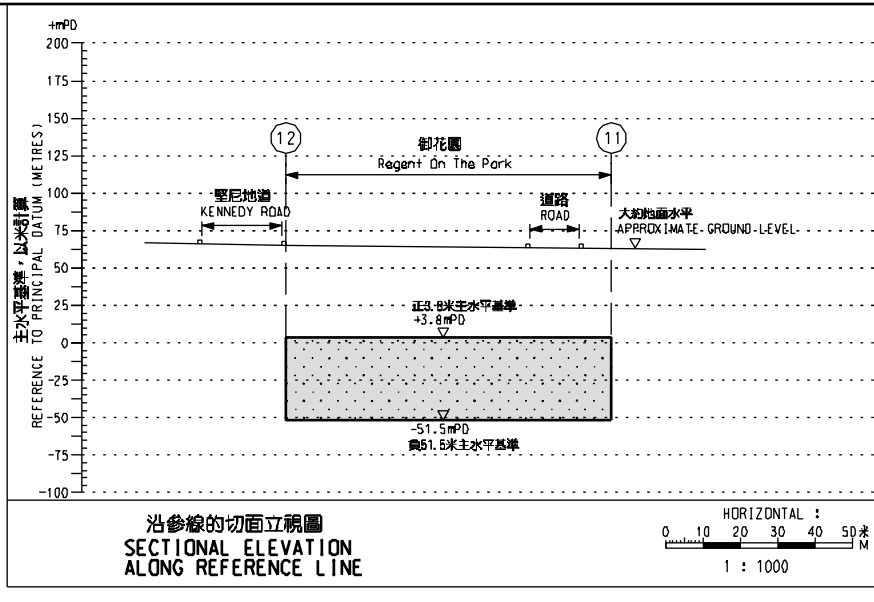
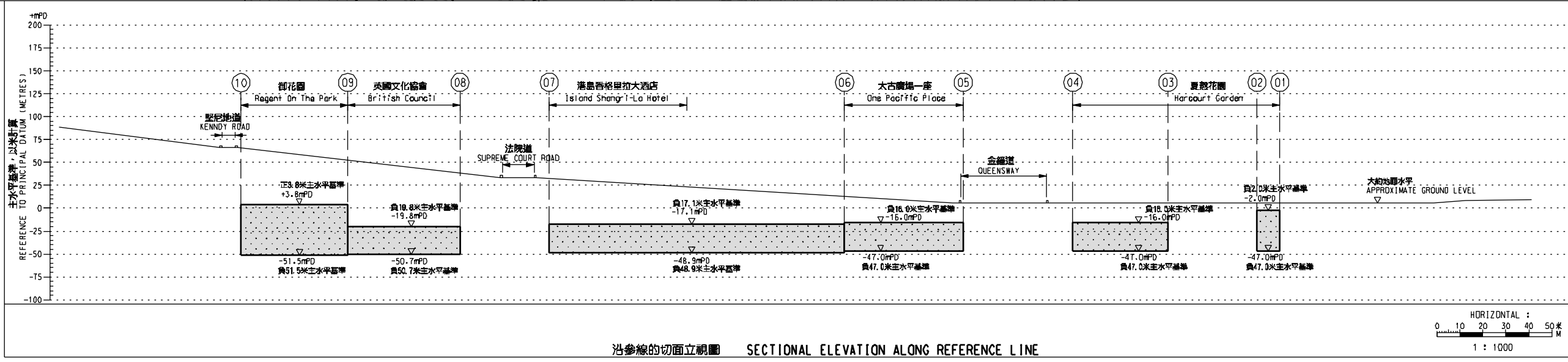
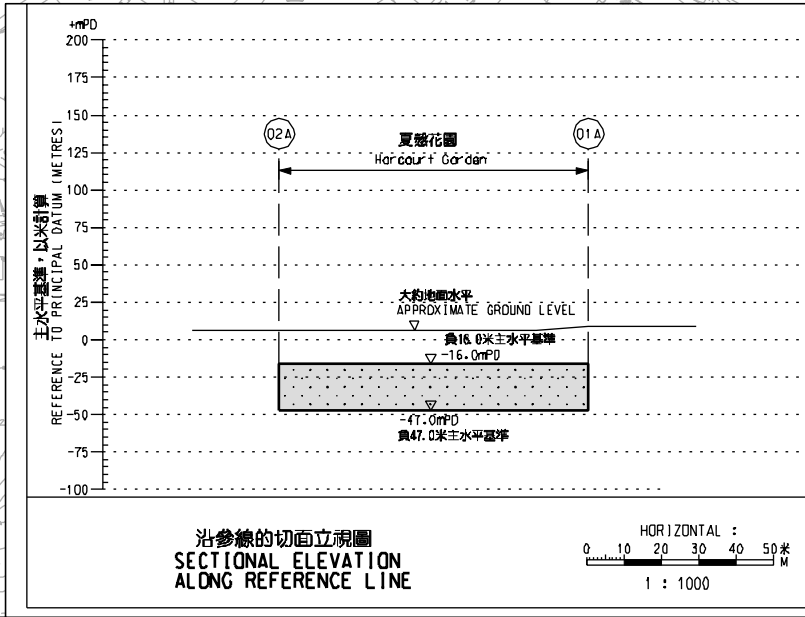

修訂表
TABLE OF AMENDMENTS

修訂 REV	日期 DATE	修訂 BY	核對 SUB	批准 APP	說明 DESCRIPTION

行書官 HO MAI FU
核准發出 APPROVED FOR ISSUE
鐵路發展處副處長(2)
GOVERNMENT ENGINEER/
RAILWAY DEVELOPMENT (2)
HIGHWAYS DEPARTMENT

發出日期 DATE OF ISSUE

圖則名稱 DRAWING TITLE
南港島線(東段)
鐵路條例(第519章)
收回地層圖則 6頁的第1頁

SOUTH ISLAND LINE (EAST)
RAILWAYS ORDINANCE (CHAPTER 519)
UNDERGROUND STRATA RESUMPTION PLAN
SHEET 1 OF 6

圖號 DRAWING NO. SILE-U01
比例 SCALE 1:1000 (A1)
或如顯示
OR AS SHOWN

香港特別行政區政府
THE GOVERNMENT OF THE HONG KONG
SPECIAL ADMINISTRATIVE REGION
路政署
HIGHWAYS DEPARTMENT
鐵路拓展處
RAILWAY DEVELOPMENT OFFICE