

一般說明 GENERAL NOTES

1. 收回地層的細節在圖則第WIL-U10至WIL-U13號顯示。
DETAILS OF UNDERGROUND STRATA RESUMPTION ARE SHOWN IN DRAWING NOS. WIL-U10 TO WIL-U13.
2. 沿參線的切面立視圖顯示的正/負主水平基準均為約數。
THE +/- mPDs SHOWN IN THE SECTIONAL ELEVATION ALONG REFERENCE LINE ARE APPROXIMATE.

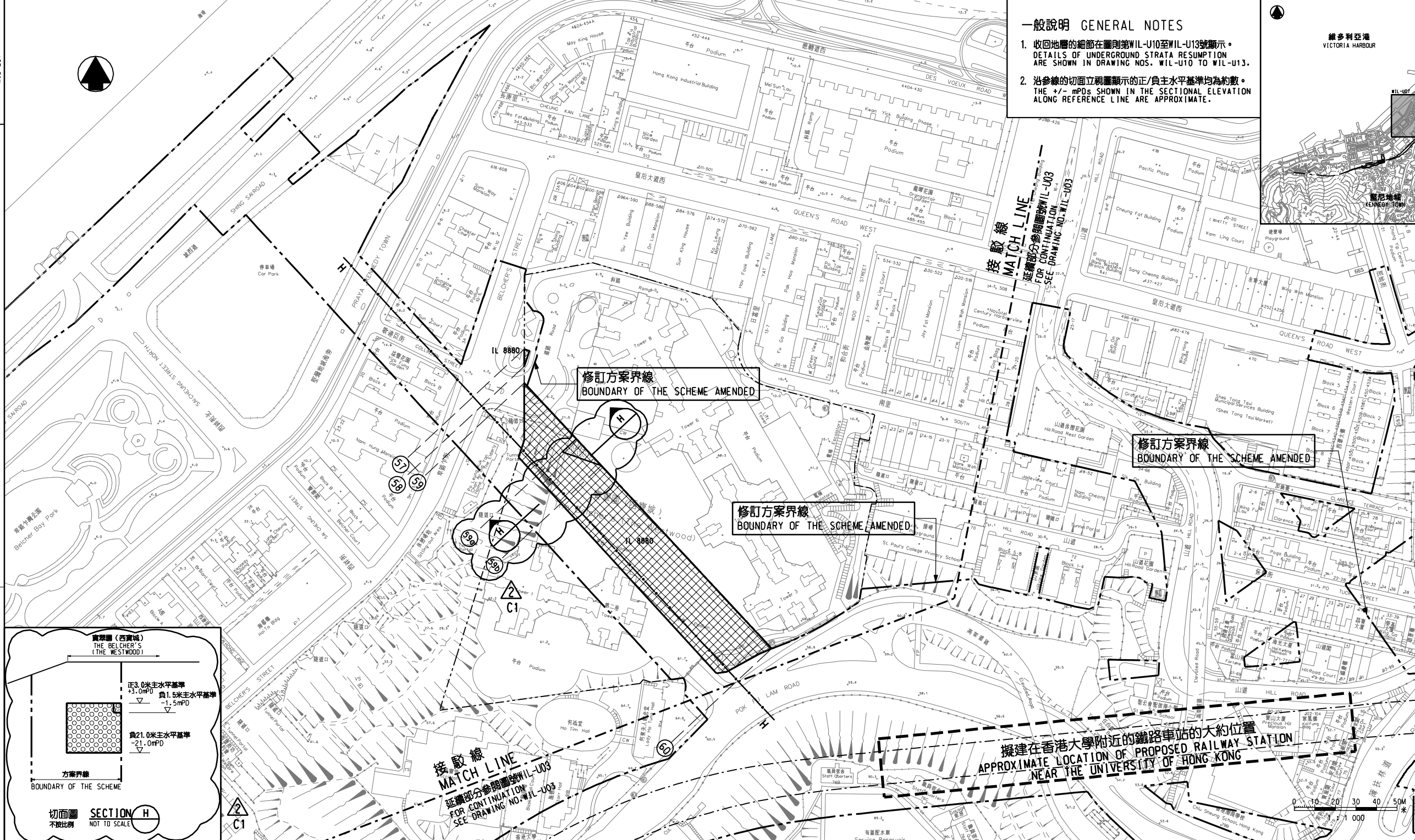
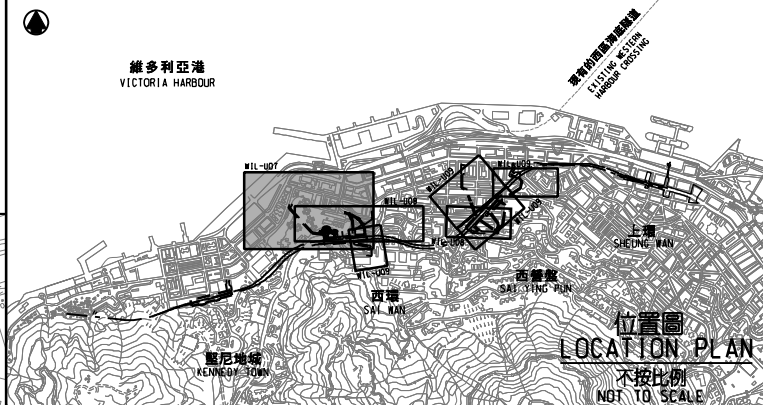

圖例 LEGEND

	方案界線 BOUNDARY OF THE SCHEME
	可收回地層的土地 LAND UNDER WHICH UNDERGROUND STRATA MAY BE RESUMED
	可收回的地層 UNDERGROUND STRATA WHICH MAY BE RESUMED
	可收回地層的土地，在該地層內的任何現有樁柱及基礎均不會收回 LAND UNDER WHICH UNDERGROUND STRATA MAY BE RESUMED. ANY EXISTING PILES AND FOUNDATIONS LOCATED WITHIN SUCH STRATA WILL NOT BE RESUMED
	可收回的地層，在該地層內的任何現有樁柱及基礎均不會收回 UNDERGROUND STRATA WHICH MAY BE RESUMED. ANY EXISTING PILES AND FOUNDATIONS LOCATED WITHIN SUCH STRATA WILL NOT BE RESUMED
	擬建的鐵路車站 PROPOSED RAILWAY STATION
	擬建的軌道中線 PROPOSED RAILWAY TRACK CENTRE LINE
	地段界線 LOT BOUNDARY
	參線標記 REFERENCE LINE MARK
	參線 REFERENCE LINE
	內地段 INLAND LOT
	圖則修改 DRAWING REVISION
	更正參者編號(參看憲報公告) CORRECTION REFERENCE NUMBER (SEE GAZETTE NOTICE)
	更正範圍 CORRECTION AREA

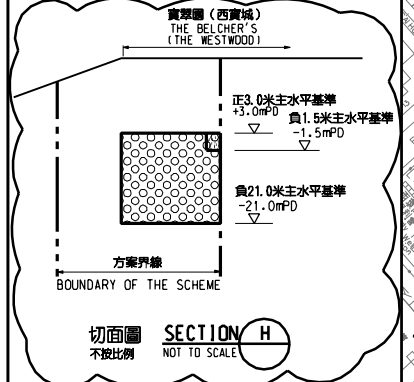

修訂表 TABLE OF AMENDMENTS

修訂日期	修訂人	類別	說明	
29 DEC 2006	KW	DN	PP	更正項目 C1 CORRECTION ITEM C1
25 AUG 2006	OC	DN	PP	修訂項目 A3, A8 及 A22 AMENDMENT ITEMS A3, A8 AND A22

核准發出 APPROVED FOR ISSUE

林超雄 LAM CHIU HUNG
路政署
鐵路拓展處處長(1)
GOVERNMENT ENGINEER/
RAILWAY DEVELOPMENT (1)
HIGHWAYS DEPARTMENT

發出日期 DATE OF ISSUE

圖則名稱 DRAWING TITLE

**鐵路條例(第519章)
地下鐵路(「地鐵」) - 西港島線
收回地層圖則 13頁的第7頁**

RAILWAYS ORDINANCE (CHAPTER 519)
MASS TRANSIT RAILWAY ('MTR') - WEST ISLAND LINE
UNDERGROUND STRATA RESUMPTION PLAN
SHEET 7 OF 13

圖號 DRAWING NO. WIL-U07

比例 SCALE 1:1000 (A1)

或如顯示 OR AS SHOWN

香港特別行政區政府
THE GOVERNMENT OF THE HONG KONG
SPECIAL ADMINISTRATIVE REGION

路政署
HIGHWAYS DEPARTMENT

鐵路拓展處
RAILWAY DEVELOPMENT OFFICE

