

**說明 NOTES**  
 此圖根據第 SCL-G09 號(修改)圖則訂制, 以黃色和綠色標明將暫時封閉的部分龍翔道, 及分別以杏色和紅色標明將暫時封閉的部分鳳德道和蒲崗村道。

THIS DRAWING IS PREPARED BASED ON DRAWING NO. SCL-G09 (REVISION 1) AND IS INTENDED TO SHOW THE TEMPORARY PARTIAL CLOSURE OF SECTIONS OF LUNG CHEUNG ROAD (HIGHLIGHTED IN YELLOW AND GREEN), AND THE TEMPORARY PARTIAL CLOSURE OF SECTIONS OF FUNG TAK ROAD AND PO KONG VILLAGE ROAD (HIGHLIGHTED IN BEIGE AND RED RESPECTIVELY).

- 圖例 LEGEND**
- 方案界線 (BOUNDARY OF THE SCHEME)
  - 擬建的鐵路車站及其他鐵路設施(地下) (PROPOSED RAILWAY STATION AND OTHER RAILWAY FACILITIES (UNDERGROUND))
  - 擬建的車站/車站入口/過風大樓/通風井/其他鐵路設施或永久建築物 (PROPOSED RAILWAY STATION/STATION ENTRANCES/VENTILATION BUILDINGS/VENTILATION SHAFTS/OTHER FACILITIES OR PERMANENT STRUCTURES)
  - 現有的車站及其他鐵路設施 (EXISTING STATION AND OTHER RAILWAY FACILITIES)
  - 擬用鑽挖或掘鑽或鑽爆或鑽掘(地下) (PROPOSED RAILWAY FACILITIES/TUNNEL BY BORED/MINED/DRILL AND BLAST METHOD (UNDERGROUND))
  - 擬用明挖或掘溝或掘溝(地下) (PROPOSED RAILWAY FACILITIES/TUNNEL BY CUT-AND-COVER METHOD (UNDERGROUND))
  - 可能永久封閉的道路(包括行車道、行人徑及露天地方) WHICH MAY BE CLOSED PERMANENTLY
  - 擬設置地盤的臨時工程 (PROPOSED TEMPORARY WORKS AREA FOR SITE FACILITIES)
  - 擬於政府前濱或海濱地盤施作的臨時工程(可能在土上進行填海工程(非為形成土地)或其他工程) (PROPOSED TEMPORARY WORKS AREA FOR SITE FACILITIES ON GOVERNMENT FORESHORE OR SEABED (OTHER THAN FILLING RECLAMATION (NOT FOR THE PURPOSE OF FORMING LAND) OR OTHER WORKS MAY BE CARRIED OUT))
  - 擬建的行人天橋/扶手电梯/升降機/樓梯 (PROPOSED FOOTBRIDGE/ESCALATOR/LIFT/STAIRCASE)
  - 擬建的有蓋行人通道 (PROPOSED COVERED WALKWAY)
  - 擬於政府前濱或海濱地盤施作的臨時工程(可能在土上進行填海工程(非為形成土地)或其他工程) (PROPOSED TEMPORARY WORKS AREA FOR SITE FACILITIES ON GOVERNMENT FORESHORE OR SEABED (OTHER THAN FILLING RECLAMATION (NOT FOR THE PURPOSE OF FORMING LAND) OR OTHER WORKS MAY BE CARRIED OUT))
  - 擬於政府前濱或海濱地盤施作的臨時工程(包括填海/覆土) (PROPOSED TEMPORARY WORKS AREA FOR SITE FACILITIES ON GOVERNMENT FORESHORE OR SEABED (INCLUDING PROTECTION LAYER/PROCK ARMOUR) BY (IMMERSED TUBE METHOD ON GOVERNMENT FORESHORE OR SEABED) (OTHER THAN FILLING RECLAMATION (NOT FOR THE PURPOSE OF FORMING LAND) OR OTHER WORKS MAY BE CARRIED OUT))
  - 擬建的保護結構的鐵路設施/隧道(地下) (PROPOSED RAILWAY FACILITIES/TUNNEL (UNDERGROUND) AT PROTECTION STRUCTURES)
  - 擬建於沙田中環及另一正在預備的鐵路項目(下列「另一項鐵路項目」)的鐵路設施(地下)/車站/車站入口/過風大樓/通風井/其他鐵路設施或永久建築物(下列「設施」) (PROPOSED RAILWAY FACILITIES/TUNNEL (INCLUDING PROTECTION LAYER/PROCK ARMOUR) BY (IMMERSED TUBE METHOD ON GOVERNMENT FORESHORE OR SEABED) (OTHER THAN FILLING RECLAMATION (NOT FOR THE PURPOSE OF FORMING LAND) OR OTHER WORKS MAY BE CARRIED OUT))
  - 受影響的政府前濱或海濱地盤的大約範圍 (APPROXIMATE EXTENT OF AFFECTED GOVERNMENT FORESHORE OR SEABED)
  - 圖則修改 (DRAWING REVISION)
  - 修訂參考編號(參閱憲報公告) (AMENDMENT REFERENCE NUMBER (SEE GAZETTE NOTICE))
  - 修訂範圍 (AMENDMENT AREA)

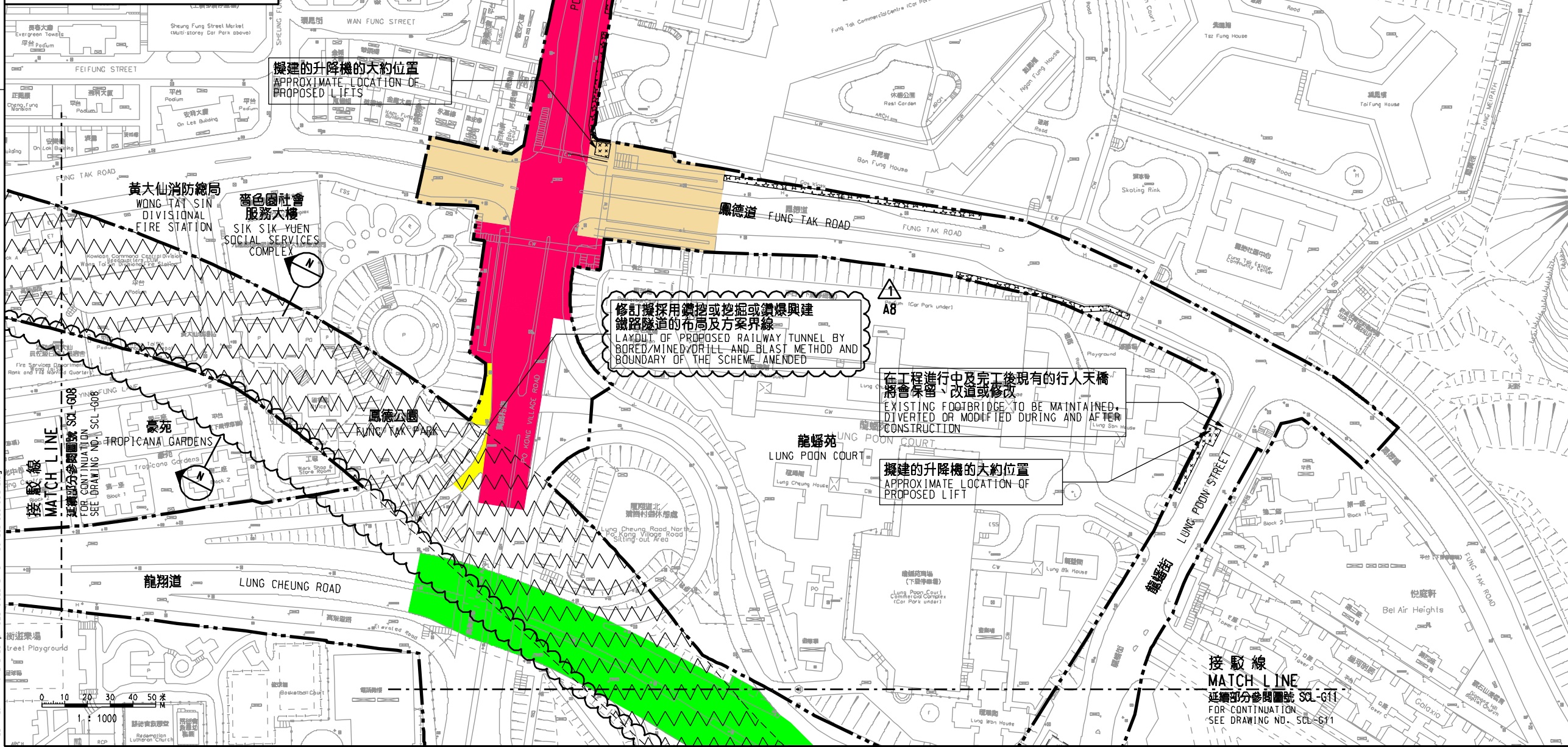

擬建的升降機的大約位置  
 APPROXIMATE LOCATION OF PROPOSED LIFTS

修訂擬採用鑽挖或掘鑽或鑽爆與建鐵路隧道的布局及方案界線  
 LAYOUT OF PROPOSED RAILWAY TUNNEL BY BORED/MINED/DRILL AND BLAST METHOD AND BOUNDARY OF THE SCHEME AMENDED

在工程進行中及完工後現有的行人天橋將會保留、改道或修改  
 EXISTING FOOTBRIDGE TO BE MAINTAINED, DIVERTED OR MODIFIED DURING AND AFTER CONSTRUCTION

擬建的升降機的大約位置  
 APPROXIMATE LOCATION OF PROPOSED LIFT

接駁線  
 MATCH LINE  
 延續部分參閱圖號 SCL-G11  
 FOR CONTINUATION  
 SEE DRAWING NO. SCL-G11

**一般說明 GENERAL NOTES**  
 1. 有關一般說明參閱圖號 SCL-G01.  
 FOR GENERAL NOTES, REFER TO DRAWING NO. SCL-G01.

TABLE OF AMENDMENTS

修訂號	日期	修訂	理由
REV	DATE	BY	DESCRIPTION

**SIGNED**  
 簽發日期 DATE OF ISSUE: 27/3/2017  
 簽署人 ANTHONY YUEN  
 職銜 總工程師/鐵路發展(1-3)  
 CHIEF ENGINEER/RAILWAY DEVELOPMENT (1-3)  
 HIGHWAYS DEPARTMENT

圖則名稱 DRAWING TITLE:  
**鐵路條例(第519章)**  
**沙田至中環線**  
**暫時封閉龍翔道、鳳德道和蒲崗村道**  
 RAILWAYS ORDINANCE (CHAPTER 519)  
**SHATIN TO CENTRAL LINK**  
**TEMPORARY CLOSURE OF SECTIONS OF LUNG CHEUNG ROAD, FUNG TAK ROAD AND PO KONG VILLAGE ROAD**

圖號 DRAWING NO.: SCL/G09/0015/5  
 比例 SCALE: 1:1000 (A1)  
 或顯示 AS SHOWN

香港特別行政區政府  
 THE GOVERNMENT OF THE HONG KONG  
 SPECIAL ADMINISTRATIVE REGION  
**路政署**  
 HIGHWAYS DEPARTMENT  
**鐵路拓展處**  
 RAILWAY DEVELOPMENT OFFICE

Plot No. 118, 119, 120, 121, 122, 123, 124, 125, 126, 127, 128, 129, 130, 131, 132, 133, 134, 135, 136, 137, 138, 139, 140, 141, 142, 143, 144, 145, 146, 147, 148, 149, 150, 151, 152, 153, 154, 155, 156, 157, 158, 159, 160, 161, 162, 163, 164, 165, 166, 167, 168, 169, 170, 171, 172, 173, 174, 175, 176, 177, 178, 179, 180, 181, 182, 183, 184, 185, 186, 187, 188, 189, 190, 191, 192, 193, 194, 195, 196, 197, 198, 199, 200, 201, 202, 203, 204, 205, 206, 207, 208, 209, 210, 211, 212, 213, 214, 215, 216, 217, 218, 219, 220, 221, 222, 223, 224, 225, 226, 227, 228, 229, 230, 231, 232, 233, 234, 235, 236, 237, 238, 239, 240, 241, 242, 243, 244, 245, 246, 247, 248, 249, 250, 251, 252, 253, 254, 255, 256, 257, 258, 259, 260, 261, 262, 263, 264, 265, 266, 267, 268, 269, 270, 271, 272, 273, 274, 275, 276, 277, 278, 279, 280, 281, 282, 283, 284, 285, 286, 287, 288, 289, 290, 291, 292, 293, 294, 295, 296, 297, 298, 299, 300, 301, 302, 303, 304, 305, 306, 307, 308, 309, 310, 311, 312, 313, 314, 315, 316, 317, 318, 319, 320, 321, 322, 323, 324, 325, 326, 327, 328, 329, 330, 331, 332, 333, 334, 335, 336, 337, 338, 339, 340, 341, 342, 343, 344, 345, 346, 347, 348, 349, 350, 351, 352, 353, 354, 355, 356, 357, 358, 359, 360, 361, 362, 363, 364, 365, 366, 367, 368, 369, 370, 371, 372, 373, 374, 375, 376, 377, 378, 379, 380, 381, 382, 383, 384, 385, 386, 387, 388, 389, 390, 391, 392, 393, 394, 395, 396, 397, 398, 399, 400, 401, 402, 403, 404, 405, 406, 407, 408, 409, 410, 411, 412, 413, 414, 415, 416, 417, 418, 419, 420, 421, 422, 423, 424, 425, 426, 427, 428, 429, 430, 431, 432, 433, 434, 435, 436, 437, 438, 439, 440, 441, 442, 443, 444, 445, 446, 447, 448, 449, 450, 451, 452, 453, 454, 455, 456, 457, 458, 459, 460, 461, 462, 463, 464, 465, 466, 467, 468, 469, 470, 471, 472, 473, 474, 475, 476, 477, 478, 479, 480, 481, 482, 483, 484, 485, 486, 487, 488, 489, 490, 491, 492, 493, 494, 495, 496, 497, 498, 499, 500, 501, 502, 503, 504, 505, 506, 507, 508, 509, 510, 511, 512, 513, 514, 515, 516, 517, 518, 519, 520, 521, 522, 523, 524, 525, 526, 527, 528, 529, 530, 531, 532, 533, 534, 535, 536, 537, 538, 539, 540, 541, 542, 543, 544, 545, 546, 547, 548, 549, 550, 551, 552, 553, 554, 555, 556, 557, 558, 559, 560, 561, 562, 563, 564, 565, 566, 567, 568, 569, 570, 571, 572, 573, 574, 575, 576, 577, 578, 579, 580, 581, 582, 583, 584, 585, 586, 587, 588, 589, 590, 591, 592, 593, 594, 595, 596, 597, 598, 599, 600, 601, 602, 603, 604, 605, 606, 607, 608, 609, 610, 611, 612, 613, 614, 615, 616, 617, 618, 619, 620, 621, 622, 623, 624, 625, 626, 627, 628, 629, 630, 631, 632, 633, 634, 635, 636, 637, 638, 639, 640, 641, 642, 643, 644, 645, 646, 647, 648, 649, 650, 651, 652, 653, 654, 655, 656, 657, 658, 659, 660, 661, 662, 663, 664, 665, 666, 667, 668, 669, 670, 671, 672, 673, 674, 675, 676, 677, 678, 679, 680, 681, 682, 683, 684, 685, 686, 687, 688, 689, 690, 691, 692, 693, 694, 695, 696, 697, 698, 699, 700, 701, 702, 703, 704, 705, 706, 707, 708, 709, 710, 711, 712, 713, 714, 715, 716, 717, 718, 719, 720, 721, 722, 723, 724, 725, 726, 727, 728, 729, 730, 731, 732, 733, 734, 735, 736, 737, 738, 739, 740, 741, 742, 743, 744, 745, 746, 747, 748, 749, 750, 751, 752, 753, 754, 755, 756, 757, 758, 759, 760, 761, 762, 763, 764, 765, 766, 767, 768, 769, 770, 771, 772, 773, 774, 775, 776, 777, 778, 779, 780, 781, 782, 783, 784, 785, 786, 787, 788, 789, 790, 791, 792, 793, 794, 795, 796, 797, 798, 799, 800, 801, 802, 803, 804, 805, 806, 807, 808, 809, 810, 811, 812, 813, 814, 815, 816, 817, 818, 819, 820, 821, 822, 823, 824, 825, 826, 827, 828, 829, 830, 831, 832, 833, 834, 835, 836, 837, 838, 839, 840, 841, 842, 843, 844, 845, 846, 847, 848, 849, 850, 851, 852, 853, 854, 855, 856, 857, 858, 859, 860, 861, 862, 863, 864, 865, 866, 867, 868, 869, 870, 871, 872, 873, 874, 875, 876, 877, 878, 879, 880, 881, 882, 883, 884, 885, 886, 887, 888, 889, 890, 891, 892, 893, 894, 895, 896, 897, 898, 899, 900, 901, 902, 903, 904, 905, 906, 907, 908, 909, 910, 911, 912, 913, 914, 915, 916, 917, 918, 919, 920, 921, 922, 923, 924, 925, 926, 927, 928, 929, 930, 931, 932, 933, 934, 935, 936, 937, 938, 939, 940, 941, 942, 943, 944, 945, 946, 947, 948, 949, 950, 951, 952, 953, 954, 955, 956, 957, 958, 959, 960, 961, 962, 963, 964, 965, 966, 967, 968, 969, 970, 971, 972, 973, 974, 975, 976, 977, 978, 979, 980, 981, 982, 983, 984, 985, 986, 987, 988, 989, 990, 991, 992, 993, 994, 995, 996, 997, 998, 999, 1000.