

C:\Program Files\Bentley\BES\Workspace Users\XRL_janf-ro-2009\Apr-Amendments_Map.ucf - UserRef: C:\Program Files\Bentley\BES\Workspace\projects\unified\pc1\... XRL/645/0021/3

一般說明 GENERAL NOTES

1. 切面圖所示鐵路設施的形狀和輪廓均屬示意性質。 GEOMETRY AND CONFIGURATION OF RAILWAY FACILITIES SHOWN IN SECTIONS ARE SCHEMATIC.
2. 所有在方案界線內的道路 (包括行車道、行人徑及露天地方), 無論有否在圖則中顯示, 都有可能永久或暫時封閉或大幅改動。 ALL ROADS INCLUDING CARRIAGEWAYS, FOOTPATHS AND OPEN PLACES WITHIN THE BOUNDARY OF THE SCHEME, WHETHER OR NOT SHOWN ON THE DRAWINGS MAY BE CLOSED OR ALTERED SUBSTANTIALLY ON A PERMANENT OR TEMPORARY BASIS.
3. 除非圖則中特別註明, 否則在方案界線內, 或與方案界線毗鄰的所有建築物、汽車通道及行人通道, 包括逃生路徑, 將會保留。 UNLESS NOTED OTHERWISE ON THE DRAWINGS, VEHICULAR AND PEDESTRIAN ACCESSES INCLUDING MEANS OF ESCAPE TO AND FROM ALL BUILDINGS WITHIN OR ADJACENT TO THE BOUNDARY OF THE SCHEME ARE TO BE MAINTAINED.
4. 所有水平均為約數, 以米為單位, 並高於香港的主水平基準。 ALL LEVELS ARE APPROXIMATE AND IN METRES ABOVE HONG KONG PRINCIPAL DATUM (mPD).
5. 圖則顯示的建造方法分界線只是大概位置, 有關界線可因應當時的地盤情況而作出改動。 BOUNDARIES SHOWN ON DRAWINGS FOR THE CONSTRUCTION METHODS TO BE CARRIED OUT ARE APPROXIMATE ONLY. THESE BOUNDARIES MAY BE ALTERED ON SITE TO SUIT PREVAILING SITE CONDITIONS.

說明 NOTES

此圖根據第XRL-G45號 (修改2) 圖則制訂, 以綠色標明將暫時封閉由連翔道至港鐵九龍站過境巴士總站的連接路, 以及以紅色標明將暫時封閉的部分匯翔道路段。

THIS DRAWING IS PREPARED BASED ON DRAWING NO. XRL-G45 (REVISION 2) AND IS INTENDED TO SHOW THE TEMPORARY CLOSURE OF THE SLIP ROAD FROM LIN CHEUNG ROAD TO CROSS-BORDER COACH TERMINUS AT MTR KOWLOON STATION (HIGHLIGHTED IN GREEN), AND THE TEMPORARY PARTIAL CLOSURE OF SECTIONS OF WUI CHEUNG ROAD (HIGHLIGHTED IN RED).

FOR CONTINUATION
SEE DRAWING NO. XRL-G44



C:\Program Files\Bentley\BES\Workspace Users\XRL_janf-ro-2009\Apr-Amendments_Map.ucf - UserRef: C:\Program Files\Bentley\BES\Workspace\projects\unified\pc1\... XRL/645/0021/3

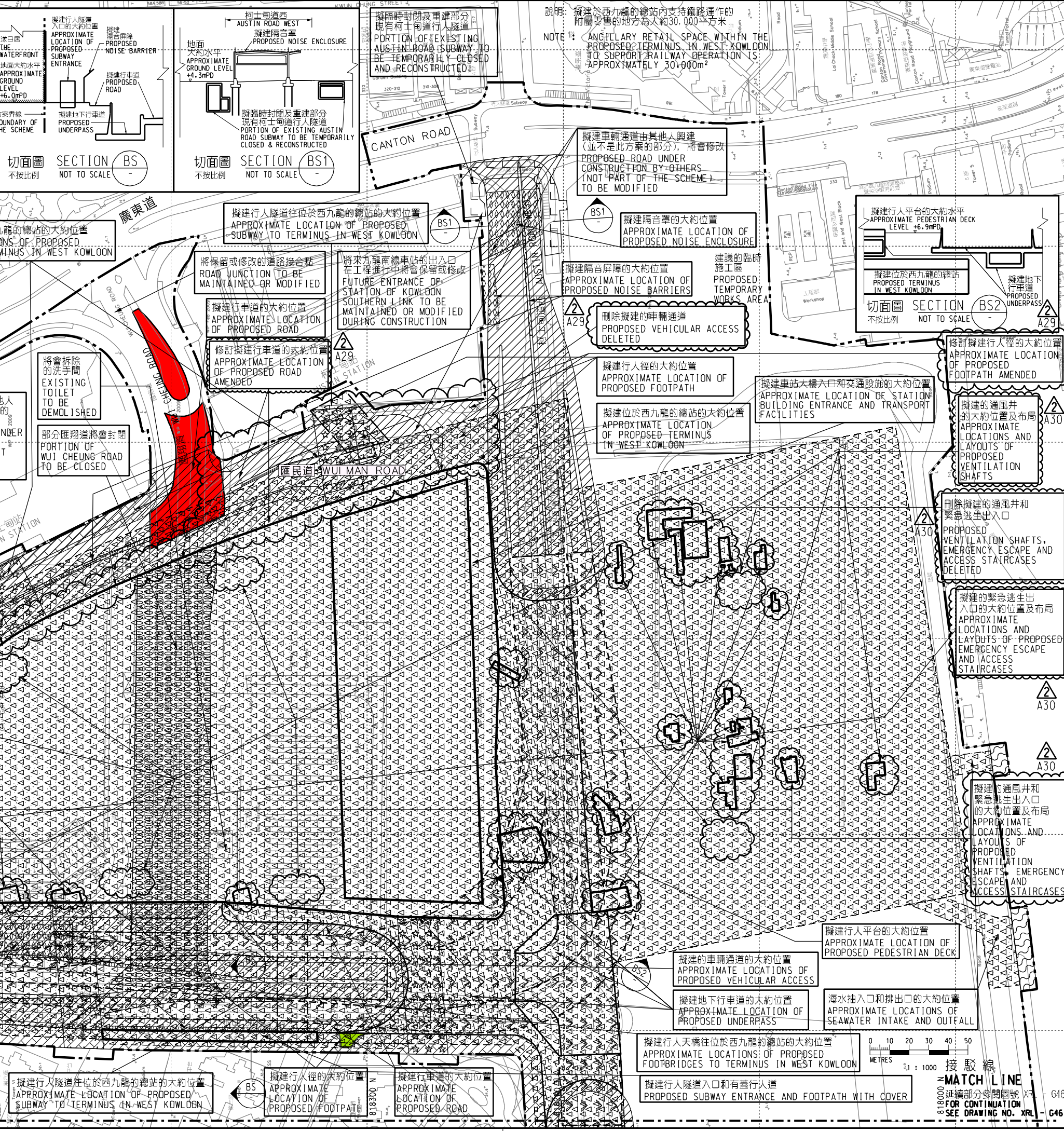

圖例 LEGEND

- 方案界線
BOUNDARY OF THE SCHEME
- 擬建的車站及其他鐵路設施
PROPOSED STATION AND OTHER RAILWAY FACILITIES
- 擬建的車站及其他鐵路設施(地下)
PROPOSED STATION AND OTHER RAILWAY FACILITIES (UNDERGROUND)
- 擬建的鑽挖或炸裂或鑽掘隧道
PROPOSED BORED / MINED / DRILL AND BLAST TUNNEL
- 擬採用明挖回填法興建的鐵路設施或隧道
PROPOSED RAILWAY FACILITIES/TUNNEL BY CUT-AND-COVER METHOD
- 擬建的地下臨時建築通道
PROPOSED TEMPORARY UNDERGROUND CONSTRUCTION ACCESS
- 可能永久封閉的道路(包括行車道和行人徑)
ROADS (INCLUDING CARRIAGEWAY AND FOOTPATH) WHICH MAY BE CLOSED PERMANENTLY
- 擬建的緊急車輛通道及行車道
PROPOSED EMERGENCY VEHICULAR ACCESS AND CARRIAGEWAY
- 擬建的行人徑
PROPOSED FOOTPATH
- 現有的行人天橋將受影響
EXISTING FOOTBRIDGE TO BE AFFECTED
- 擬建的臨時行人天橋/地面行人過路處
PROPOSED TEMPORARY FOOTBRIDGE / AT-GRADE PEDESTRIAN CROSSING
- 擬建的行人天橋
PROPOSED FOOTBRIDGE
- 可能在其上進行填海工程或其他工程的政府前濱或海床
GOVERNMENT FORESHORE OR SEABED OVER OR UPON WHICH RECLAMATION OR OTHER WORKS MAY BE CARRIED OUT
- 擬建的隔音屏障/隔音罩
PROPOSED NOISE BARRIER / NOISE ENCLOSURE
- 擬建臨時拆除及重建部分現有柯士甸行人隧道
PORTION OF EXISTING AUSTIN ROAD SUBWAY TO BE TEMPORARILY REMOVED & RECONSTRUCTED
- 擬建的地下行車道
PROPOSED UNDERPASS
- 擬建行人平台
PROPOSED PEDESTRIAN DECK
- ▲ 圖則修改
DRAWING REVISION
- ▲ 修訂參考編號(參考憲報公告)
AMENDMENT REFERENCE NUMBER (SEE GAZETTE NOTICE)
- ▲ 修訂範圍
AMENDMENT AREA

REV	DATE	BY	SUB	APP	說明 DESCRIPTION

SIGNED

簽發日期 DATE OF ISSUE: 24/08/2016

簽發人 APPROVED FOR ISSUE: NGAI HON WAH
總工程師/鐵路拓展(2-1)
CHIEF ENGINEER RAILWAY DEVELOPMENT (2-1)
HONG KONG RAILWAY DEPARTMENT

圖則名稱 DRAWING TITLE: 鐵路條例 (第519章) 廣深港高速鐵路香港段 暫時封閉由連翔道至港鐵九龍站過境巴士總站的連接路以及匯翔道路段

RAILWAYS ORDINANCE (CHAPTER 519) HONG KONG SECTION OF GUANGZHOU - SHENZHEN - HONG KONG EXPRESS RAIL LINK TEMPORARY CLOSURE OF A SLIP ROAD FROM LIN CHEUNG ROAD TO CROSS-BORDER COACH TERMINUS AT MTR KOWLOON STATION AND SECTIONS OF WUI CHEUNG ROAD

圖號 DRAWING NO.: XRL/G45/0021/3

比例 SCALE: 1:1000 (A1) 或如顯示 OR AS SHOWN

香港特別行政區政府
THE GOVERNMENT OF THE HONG KONG SPECIAL ADMINISTRATIVE REGION

路政署
HIGHWAYS DEPARTMENT

鐵路拓展處
RAILWAY DEVELOPMENT OFFICE

說明: 擬建於西九龍的總站內支持鐵路運作的附屬零售的地方為大約30,000平方米

NOTE: ANCILLARY RETAIL SPACE WITHIN THE PROPOSED TERMINUS IN WEST KOWLOON TO SUPPORT RAILWAY OPERATION IS APPROXIMATELY 30,000m²

擬建車軌通道由其他人興建 (並不是此方案的部分), 將會修改

PROPOSED ROAD UNDER CONSTRUCTION BY OTHERS (NOT PART OF THE SCHEME) TO BE MODIFIED

擬建隔音罩的大約位置

APPROXIMATE LOCATION OF PROPOSED NOISE ENCLOSURE

刪除擬建的車輛通道

PROPOSED VEHICULAR ACCESS DELETED

擬建行人徑的大約位置

APPROXIMATE LOCATION OF PROPOSED FOOTPATH

擬建位於西九龍的總站的大約位置

APPROXIMATE LOCATION OF PROPOSED TERMINUS IN WEST KOWLOON

修訂擬建行人徑的大約位置

APPROXIMATE LOCATION OF PROPOSED FOOTPATH AMENDED

擬建的通風井的大約位置及布局

APPROXIMATE LOCATIONS AND LAYOUTS OF PROPOSED VENTILATION SHAFTS

刪除擬建的通風井和緊急逃生出入口

PROPOSED VENTILATION SHAFTS, EMERGENCY ESCAPE AND ACCESS STAIRCASES DELETED

擬建的緊急逃生出入口的大約位置及布局

APPROXIMATE LOCATIONS AND LAYOUTS OF PROPOSED EMERGENCY ESCAPE AND ACCESS STAIRCASES

擬建的通風井和緊急逃生出入口的大約位置及布局

APPROXIMATE LOCATIONS AND LAYOUTS OF PROPOSED VENTILATION SHAFTS, EMERGENCY ESCAPE AND ACCESS STAIRCASES

擬建行人平台的大約位置

APPROXIMATE LOCATION OF PROPOSED PEDESTRIAN DECK

擬建的車輛通道的大約位置

APPROXIMATE LOCATIONS OF PROPOSED VEHICULAR ACCESS

擬建地下行車道的大約位置

APPROXIMATE LOCATION OF PROPOSED UNDERPASS

海水抽入口和排出口的大約位置

APPROXIMATE LOCATIONS OF SEAWATER INTAKE AND OUTFALL

擬建行人天橋位於西九龍的總站的大約位置

APPROXIMATE LOCATIONS OF PROPOSED FOOTBRIDGES TO TERMINUS IN WEST KOWLOON

擬建行人隧道入口和有蓋行人道

PROPOSED SUBWAY ENTRANCE AND FOOTPATH WITH COVER

擬建隔音罩的大約位置

APPROXIMATE LOCATION OF PROPOSED NOISE ENCLOSURE

擬建隔音屏障的大約位置

APPROXIMATE LOCATION OF PROPOSED NOISE BARRIERS

擬建行人隧道位於西九龍的總站的大約位置

APPROXIMATE LOCATION OF PROPOSED SUBWAY TO TERMINUS IN WEST KOWLOON

擬建行人徑的大約位置

APPROXIMATE LOCATION OF PROPOSED FOOTPATH

擬建行車道的大約位置

APPROXIMATE LOCATION OF PROPOSED ROAD

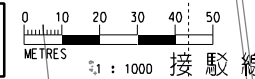

FOR CONTINUATION
SEE DRAWING NO. XRL-G46