

User: C:\Users\... Files\... XRL - G45.dwg, Plot: D:\... XRL - G45.plt, Plot Device: HP DesignJet 5000PSN, Plot Date: 22/07/2014, 11:53, PLOT BY: c:\obrac...

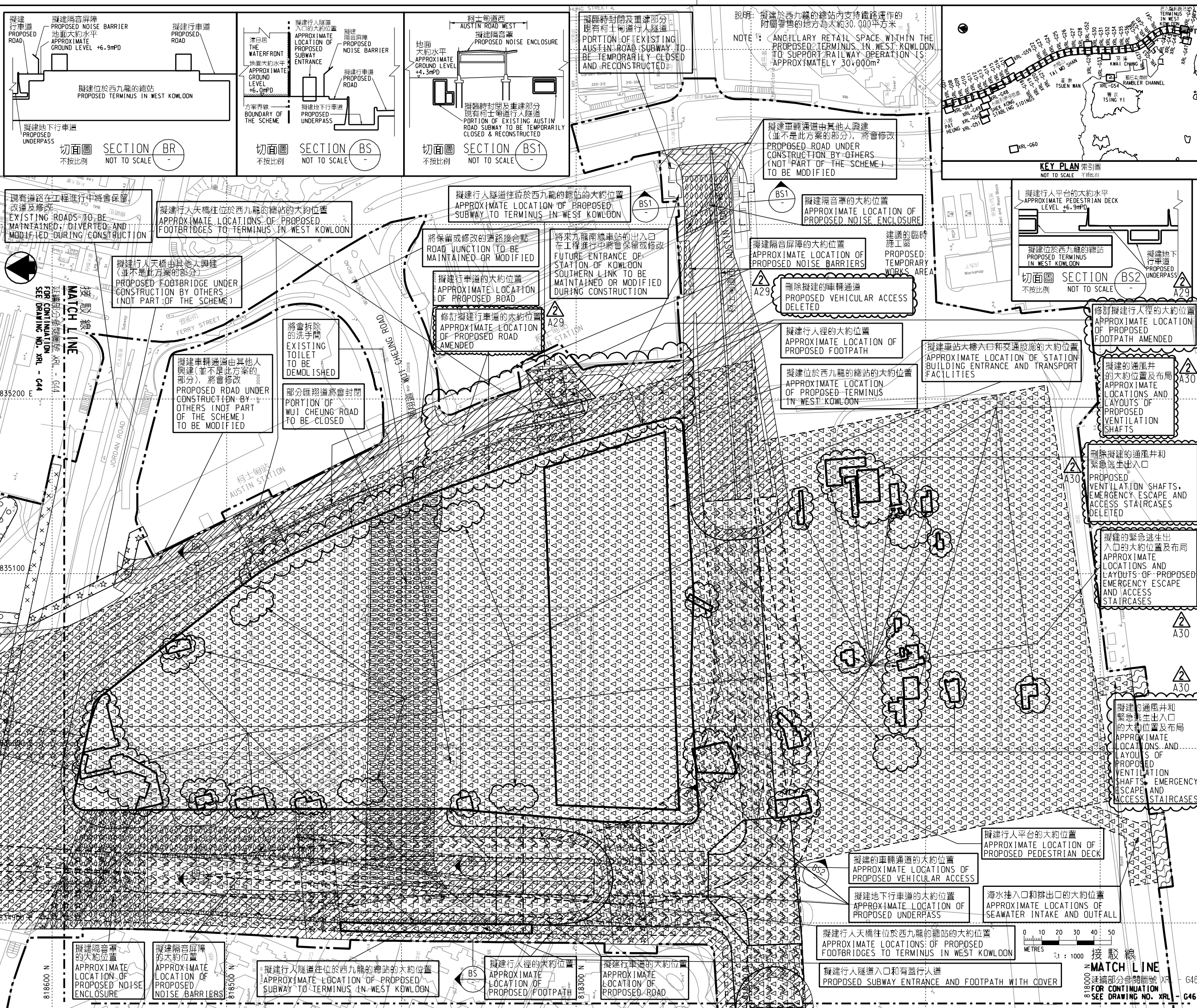

圖例 LEGEND	
[Symbol]	方案界線 BOUNDARY OF THE SCHEME
[Symbol]	擬建的車站及其他鐵路設施 PROPOSED STATION AND OTHER RAILWAY FACILITIES
[Symbol]	擬建的車站及其他鐵路設施(地下) PROPOSED STATION AND OTHER RAILWAY FACILITIES (UNDERGROUND)
[Symbol]	擬建的鑽挖或炸藥或鑽爆隧道 PROPOSED BORED / MINED / DRILL AND BLAST TUNNEL
[Symbol]	擬採用明挖回灌法興建的鐵路設施或隧道 PROPOSED RAILWAY FACILITIES/TUNNEL BY CUT-AND-COVER METHOD
[Symbol]	擬建的地下臨時建築通道 PROPOSED TEMPORARY UNDERGROUND CONSTRUCTION ACCESS
[Symbol]	可能永久封閉的道路(包括行車道和行人徑) ROADS (INCLUDING CARRIAGEWAY AND FOOTPATH) WHICH MAY BE CLOSED PERMANENTLY
[Symbol]	擬建的緊急車輛通道及行車道 PROPOSED EMERGENCY VEHICULAR ACCESS AND CARRIAGEWAY
[Symbol]	擬建的行人徑 PROPOSED FOOTPATH
[Symbol]	現有的行人天橋將受影響 EXISTING FOOTBRIDGE TO BE AFFECTED
[Symbol]	擬建的臨時行人天橋/地面行人過路處 PROPOSED TEMPORARY FOOTBRIDGE / AT-GRADE PEDESTRIAN CROSSING
[Symbol]	擬建的行人天橋 PROPOSED FOOTBRIDGE
[Symbol]	可能在其上進行填海工程或其他工程的政府前濱或海床 GOVERNMENT FORESHORE OR SEABED OVER OR UPON WHICH RECLAMATION OR OTHER WORKS MAY BE CARRIED OUT
[Symbol]	擬建的隔音屏障/隔音罩 PROPOSED NOISE BARRIER / NOISE ENCLOSURE
[Symbol]	擬臨時拆除及重建部分現有柯士甸行人隧道 PORTION OF EXISTING AUSTIN ROAD SUBWAY TO BE TEMPORARILY REMOVED & RECONSTRUCTED
[Symbol]	擬建的地下行車道 PROPOSED UNDERPASS
[Symbol]	擬建行人平台 PROPOSED PEDESTRIAN DECK
[Symbol]	圖則修改 DRAWING REVISION
[Symbol]	修訂參考編號(參考憲報公告) AMENDMENT REFERENCE NUMBER (SEE GAZETTE NOTICE)
[Symbol]	修訂範圍 AMENDMENT AREA

**一般說明 GENERAL NOTES**

1. 有關一般說明參閱圖號 XRL - G01.  
FOR GENERAL NOTES, REFER TO DRAWING NO. XRL - G01.

修訂表 TABLE OF AMENDMENTS				
日期 DATE	繪圖員 DRAWN BY	校對員 CHECKED BY	說明 DESCRIPTION	
27 JUN 2014	CDD	CH	DN	修訂項目 A29 及 A30 AMENDMENT ITEMS A29 AND A30
17 APR 2009	CDD	DN	PP	修訂項目 A17 AMENDMENT ITEM A17 修訂範圍方格內內容及索引圖 TITLE BOX AND KEY PLAN AMENDED

**SIGNED**

核准發出 APPROVED FOR ISSUE: 24/07/2014  
發出日期 DATE OF ISSUE: 24/07/2014

圖則名稱 DRAWING TITLE: 廣深港高速鐵路香港段 鐵路條例(第519章) 總體規劃圖則 66頁的第45頁  
HONG KONG SECTION OF GUANGZHOU - SHENZHEN - HONG KONG EXPRESS RAIL LINK RAILWAYS ORDINANCE (CHAPTER 519) GENERAL LAYOUT PLAN SHEET 45 OF 66

圖號 DRAWING NO.: XRL - G45  
比例 SCALE: 1:1000 (A1)  
或如顯示 OR AS SHOWN

香港特別行政區政府 THE GOVERNMENT OF THE HONG KONG SPECIAL ADMINISTRATIVE REGION  
路政署 HIGHWAYS DEPARTMENT  
鐵路拓展處 RAILWAY DEVELOPMENT OFFICE