

連接圖則編號 91272/GAZ/1004

CONTINUED ON PLAN NO. 91272/GAZ/1004

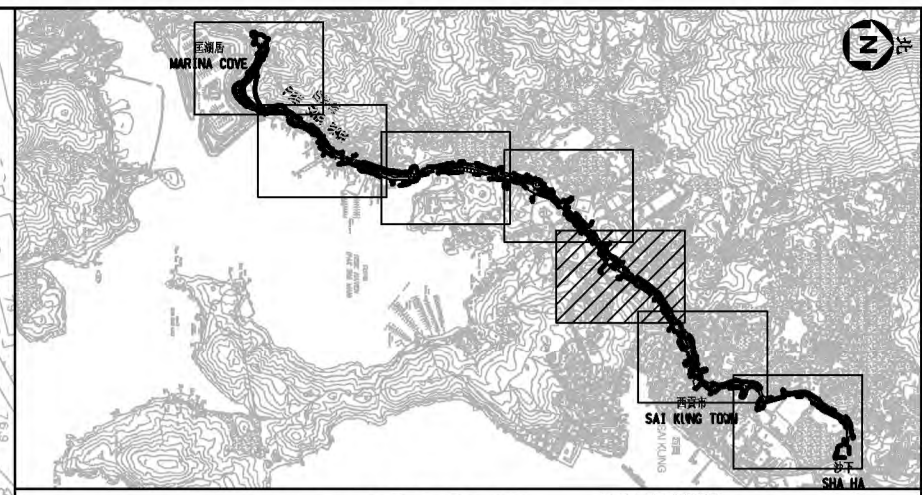

索引圖 KEY PLAN 比例 1:140000 SCALE 1:140000

註釋 NOTES :

- 除在其他方面指定外，所有量度以米為單位。
ALL DIMENSIONS ARE IN METRES UNLESS OTHERWISE STATED.
- 所有水平均為約數，以米為單位，並在香港主水平基準上。
ALL LEVELS ARE APPROXIMATE VALUES AND IN METRES ABOVE HONG KONG PRINCIPAL DATUM.
- 如有需要，施工區界限內部分現有行車道、行人路、中央分隔帶/安全島及美化市容地帶或將分階段暫時封閉。
SECTIONS OF THE EXISTING CARRIAGEWAYS, FOOTPATHS, CENTRAL MEDIANS/REFUGE ISLANDS AND AMENITY AREAS WITHIN THE LIMIT OF WORKS AREA MAY BE TEMPORARILY CLOSED IN PHASES AS AND WHEN REQUIRED.

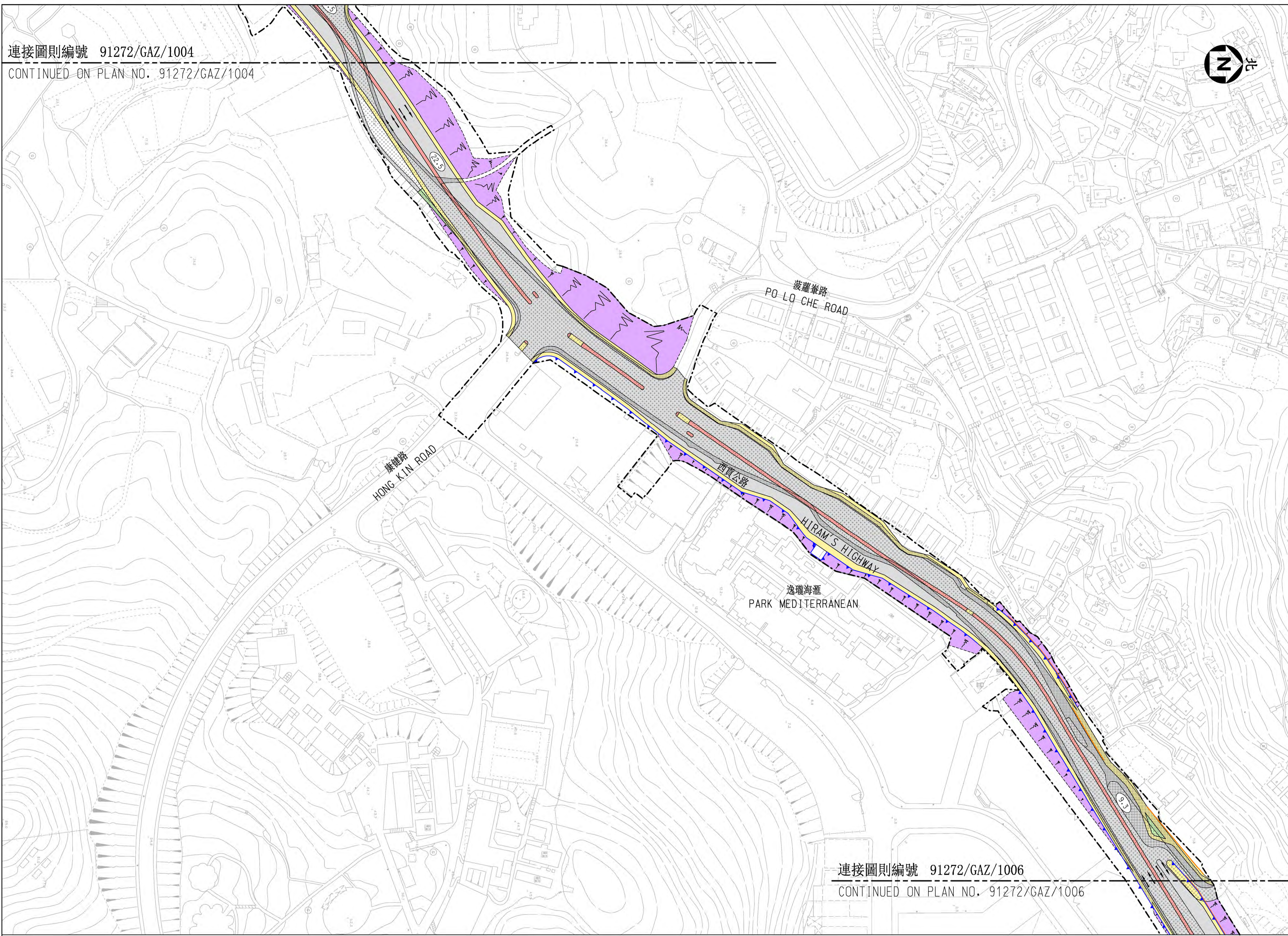

連接圖則編號 91272/GAZ/1006

CONTINUED ON PLAN NO. 91272/GAZ/1006

LEGEND 圖例 :

- | | | | | | | |
|-------------------------------|--|---|--|---|--|--|
| 施工區界限
LIMIT OF WORKS AREA | 擬建中央分隔帶/安全島
PROPOSED CENTRAL MEDIAN/REFUGE ISLAND | 擬建升降機
PROPOSED LIFT | 現有中央分隔帶/安全島將永久封閉及拆卸
EXISTING CENTRAL MEDIAN/REFUGE ISLAND TO BE PERMANENTLY CLOSED AND DEMOLISHED | 現有行人路將暫時封閉及重建
EXISTING FOOTPATH TO BE TEMPORARILY CLOSED AND RECONSTRUCTED | 擬建隔音屏障
PROPOSED NOISE BARRIER | 行車方向
(每一個箭頭表示一條行車線)
TRAFFIC DIRECTION
(ONE ARROW REPRESENTS ONE LANE) |
| 擬建行車道
PROPOSED CARRIAGEWAY | 擬建美化市容地帶
PROPOSED AMENITY AREA | 現有行車道將永久封閉及拆卸
EXISTING CARRIAGEWAY TO BE PERMANENTLY CLOSED AND DEMOLISHED | 現有美化市容地帶將暫時封閉及重建
EXISTING AMENITY AREA TO BE TEMPORARILY CLOSED AND RECONSTRUCTED | 擬建護土牆
PROPOSED RETAINING WALL | 擬建水平(約數)
PROPOSED LEVEL (APPROXIMATE) | |
| 擬建行人路
PROPOSED FOOTPATH | 擬建行人隧道
PROPOSED SUBWAY | 現有行人路將永久封閉及拆卸
EXISTING FOOTPATH TO BE PERMANENTLY CLOSED AND DEMOLISHED | 現有行車道將暫時封閉及重建
EXISTING CARRIAGEWAY TO BE TEMPORARILY CLOSED AND RECONSTRUCTED | 擬建的斜坡改善工程
PROPOSED SLOPE IMPROVEMENT WORKS | | |

工程名稱 PROJECT TITLE
工務計劃項目第6806TH號
匡湖居至西貢市之間的西貢公路分隔車道工程
PWP ITEM NO. 6806TH
DUALLING OF HIRAM'S HIGHWAY
FROM MARINA COVE TO SAI KUNG TOWN

圖則名稱 PLAN TITLE
(根據《道路(工程、使用及補償)條例》
(第370章)而在憲報公布之圖則)
PLAN FOR GAZETTING UNDER ROADS
(WORKS, USE AND COMPENSATION)
ORDINANCE (CHAPTER 370)

圖則編號 PLAN NO.
91272/GAZ/1005
(七張中的第五張)
(SHEET 5 OF 7)

版權所有 不得翻印
© Copyright Reserved
或如顯示
OR AS SHOWN

主要工程 管理處
Project Management Office



CAD File: 91272_GAZ_1005.dgn