

**圖例 LEGEND:**

	施工區界限 LIMIT OF WORKS AREA		現有通道永久封閉及改建為美化市容地帶 EXISTING ACCESS ROAD TO BE PERMANENTLY CLOSED AND CONVERTED INTO AMENITY AREA		現有斜坡拆卸及重建 EXISTING SLOPE TO BE DEMOLISHED AND RECONSTRUCTED
	擬建行車道 PROPOSED CARRIAGEWAY		現有通道永久封閉 EXISTING ACCESS ROAD TO BE PERMANENTLY CLOSED		現有行車道將暫時封閉及重建 EXISTING CARRIAGEWAY TO BE TEMPORARILY CLOSED AND RECONSTRUCTED
	擬建行人路 PROPOSED FOOTPATH		現有路旁路永久封閉及改建為斜坡 EXISTING VERGE TO BE PERMANENTLY CLOSED AND CONVERTED INTO SLOPE		現行人路將暫時封閉及重建 EXISTING FOOTPATH TO BE TEMPORARILY CLOSED AND RECONSTRUCTED
	擬建美化市容地帶 PROPOSED AMENITY AREA		現有斜坡永久封閉及改建為斜坡 EXISTING VERGE TO BE PERMANENTLY CLOSED AND CONVERTED INTO SLOPE		現行人路將暫時封閉及重建 EXISTING FOOTPATH TO BE TEMPORARILY CLOSED AND RECONSTRUCTED
	擬建斜坡 PROPOSED SLOPE		現有斜坡拆卸及改建為行車道 EXISTING SLOPE TO BE DEMOLISHED AND CONVERTED INTO CARRIAGEWAY		現有路旁路將暫時封閉及重建 EXISTING VERGE TO BE TEMPORARILY CLOSED AND RECONSTRUCTED
	現行人路將永久封閉及改建為行車道 EXISTING FOOTPATH TO BE PERMANENTLY CLOSED AND CONVERTED INTO CARRIAGEWAY		現有斜坡拆卸及改建為行人路 EXISTING SLOPE TO BE DEMOLISHED AND CONVERTED INTO FOOTPATH		現有路旁路將暫時封閉及重建 EXISTING VERGE TO BE TEMPORARILY CLOSED AND RECONSTRUCTED
	現有通道永久封閉及改建為行車道 EXISTING ACCESS ROAD TO BE PERMANENTLY CLOSED AND CONVERTED INTO CARRIAGEWAY		現有斜坡拆卸及改建為路旁 EXISTING SLOPE TO BE DEMOLISHED AND CONVERTED INTO VERGE		擬建路面水平(約數) PROPOSED ROAD LEVEL (APPROXIMATE)
	現有通道永久封閉及改建為行人路 EXISTING ACCESS ROAD TO BE PERMANENTLY CLOSED AND CONVERTED INTO FOOTPATH		現有斜坡拆卸及改建為美化市容地帶 EXISTING SLOPE TO BE DEMOLISHED AND CONVERTED INTO AMENITY AREA		

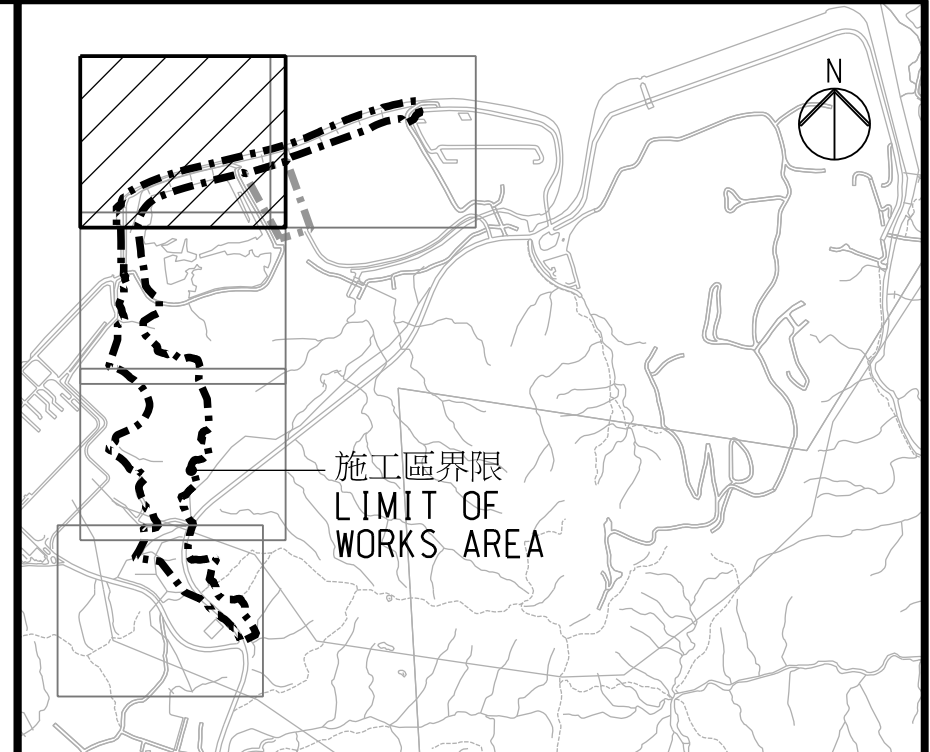

索引圖 KEY PLAN  
比例 SCALE 1:25000 (A1)

**註釋 NOTES:**

- 除在其他方面指定外，所有量度以米為單位。  
ALL DIMENSIONS ARE IN METRES UNLESS OTHERWISE STATED.
- 所有水平均為約數，以米為單位，並在香港主水平基準上。  
ALL LEVELS ARE APPROXIMATE VALUES AND IN METRES ABOVE HONG KONG PRINCIPAL DATUM.
- 如有需要，施工區界限內部分現有行車道、行人路和路旁或將分階段暫時封閉。  
SECTIONS OF THE EXISTING CARRIAGEWAYS, FOOTPATHS AND VERGE WITHIN THE LIMIT OF WORKS AREA MAY BE TEMPORARILY CLOSED IN PHASES AS AND WHEN REQUIRED.

CUT LINE A-A 連接線 A-A  
PLAN NO. 245706/GZ/002  
圖則編號 245706/GZ/002

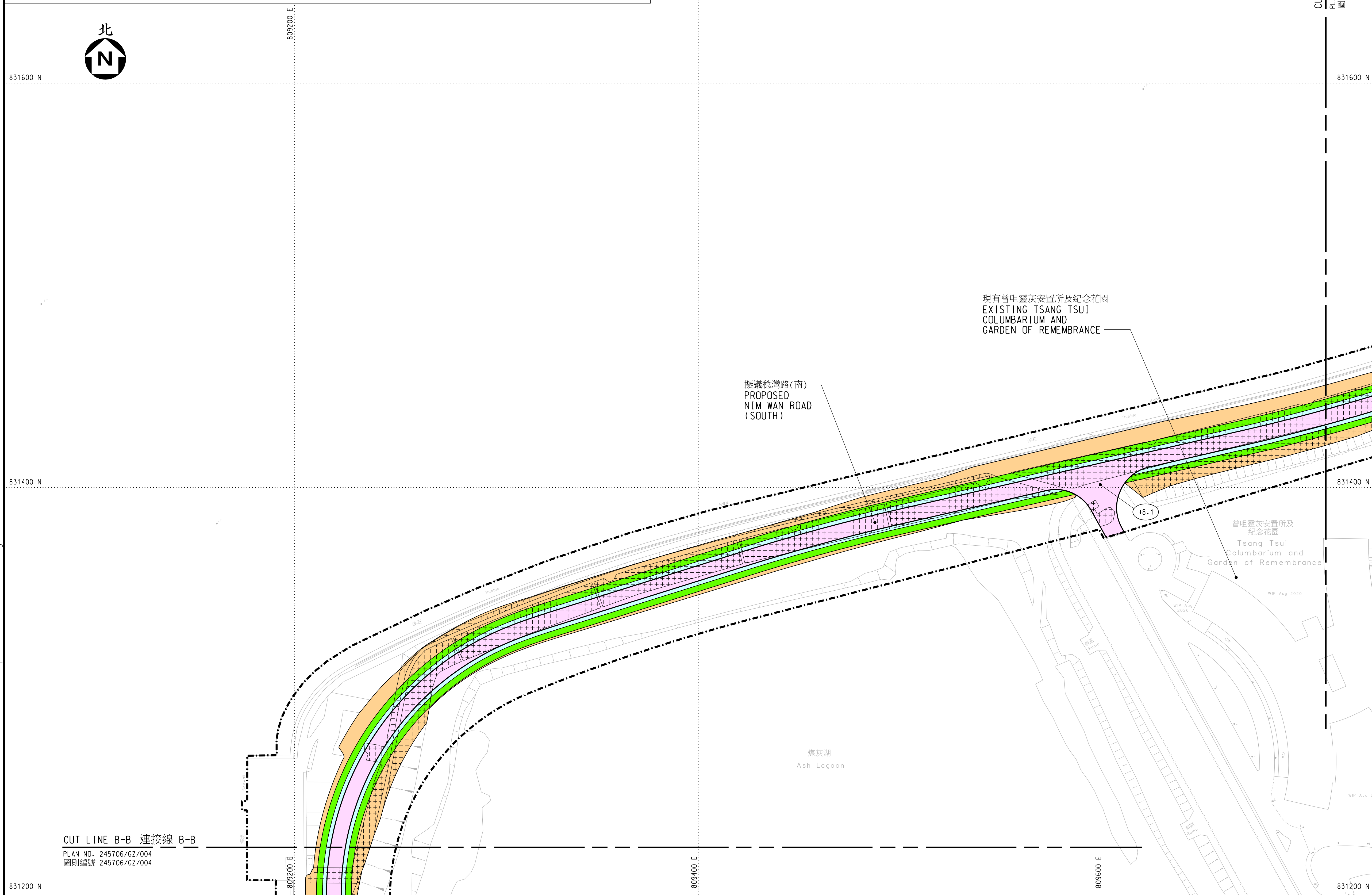

工程名稱 PROJECT TITLE	
稔灣路(南) NIM WAN ROAD (SOUTH)	
圖則名稱 PLAN TITLE	
根據 <<道路(工程、使用及補償)條例>> (第370章)而在憲報公布之圖則 PLAN FOR GAZETTING UNDER ROADS (WORKS, USE AND COMPENSATION) ORDINANCE (CHAPTER 370)	
五張之第二張 SHEET 2 OF 5	
圖則編號 PLAN NO.	比例 SCALE
245706/GZ/003	1:1000 (A1)
版權所有 不得翻印 COPYRIGHT RESERVED	

辦事處 OFFICE  
環境基建科 堆填及發展組  
LANDFILLS AND DEVELOPMENT GROUP  
ENVIRONMENTAL INFRASTRUCTURE DIVISION

環境保護署  
Environmental Protection Department

Printed by : 11/26/2021  
Filename : V:\245706\ARUP\Civil\Gazette Report\245706\_GZ\_003.dgn

CUT LINE B-B 連接線 B-B  
PLAN NO. 245706/GZ/004  
圖則編號 245706/GZ/004