

位置 LOCATION

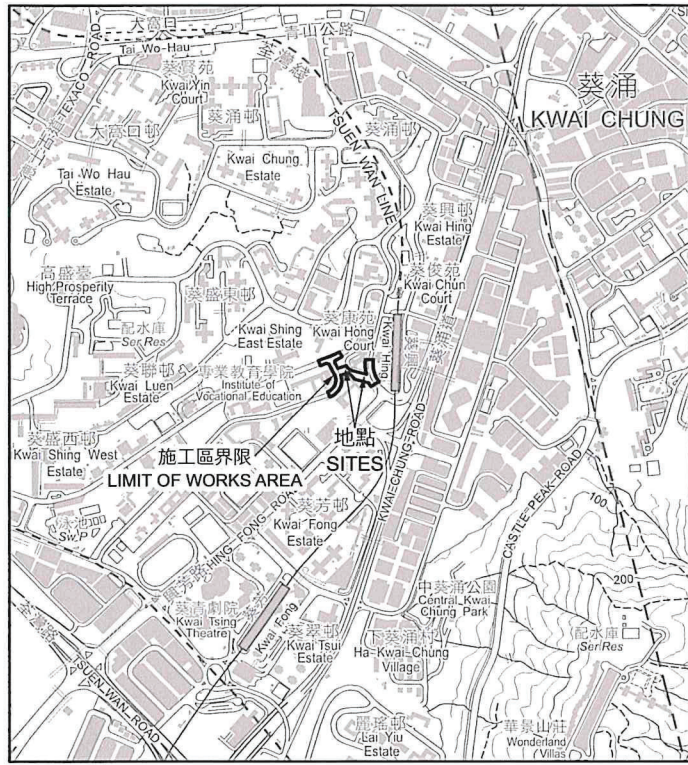

比例 SCALE 1:20 000

圖例 LEGEND

-  施工區界限
LIMIT OF WORKS AREA
-  紫色綴黑網點
Purple Stippled Black
-  設定暫時佔用土地權利的範圍
AREA FOR CREATION OF RIGHTS OF TEMPORARY OCCUPATION OF LAND

設定暫時佔用土地權利的範圍
AREA FOR CREATION OF RIGHTS OF TEMPORARY OCCUPATION OF LAND

地段編號 LOT No.	面積以平方米計(約數) AREA IN SQUARE METRES (ABOUT)
葵涌市地段第319號餘段(部分) KCTL 319 RP (PORTION)	508.6
葵涌市地段第420號(部分) KCTL 420 (PORTION)	285.7
總面積 TOTAL AREA	794.3

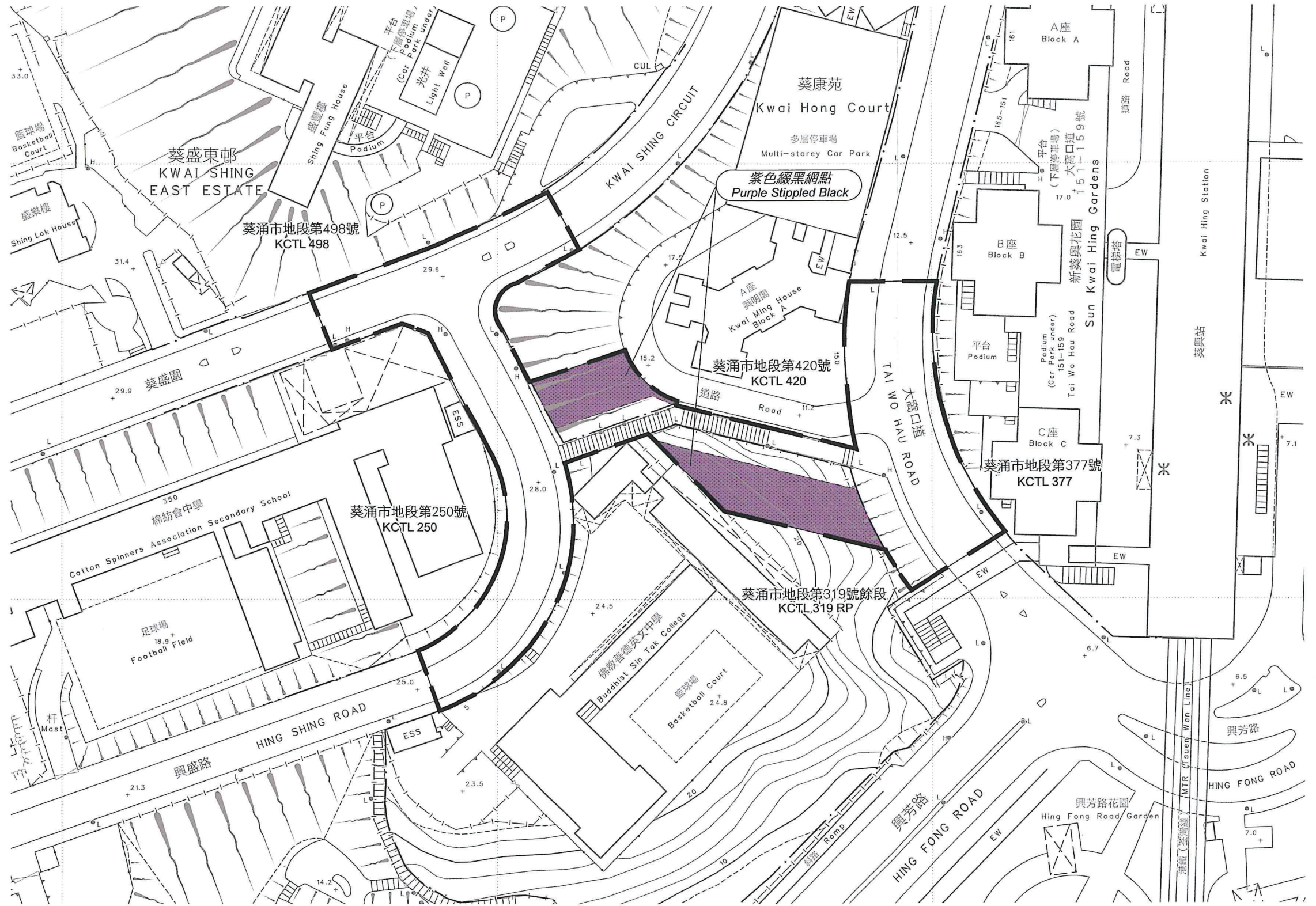

比例尺 SCALE 1:1 000

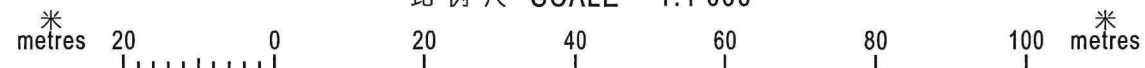

只作識別用
FOR IDENTIFICATION PURPOSES ONLY

(何敏儀 M. Y. HO)
荃灣葵青地政專員
District Lands Officer, Tsuen Wan and Kwai Tsing
日期 Date 26 NOV 2021

設定暫時佔用土地權利之圖則
道路(工程、使用及補償)條例(第370章)
工務計劃項目第6197TB號 -
興盛路至大窩口道行人通道系統
PLAN FOR CREATION OF RIGHTS OF TEMPORARY OCCUPATION OF LAND
ROADS (WORKS, USE AND COMPENSATION) ORDINANCE (CHAPTER 370)
PWP ITEM No. 6197TB -
PEDESTRIAN WALKWAY SYSTEM BETWEEN
HING SHING ROAD AND TAI WO HAU ROAD

檔案編號 File No. DLO/TWKT/KT 3/983/2021
測量圖編號 Survey Sheet Nos. 7-SW-21B & 22A
發展藍圖編號 Layout Plan No. ---
參考圖編號 Reference Plan No. Q1028/T/LD/021(Rev.C) (路政署 HyD)
圖則編號 PLAN No. KTM2339b