

位置圖
LOCATION PLAN
比例 Scale 1 : 2500 @ A1



插圖 A (不按比例)
INSET A (NOT TO SCALE)

行人隧道面
AT SUBWAY LEVEL

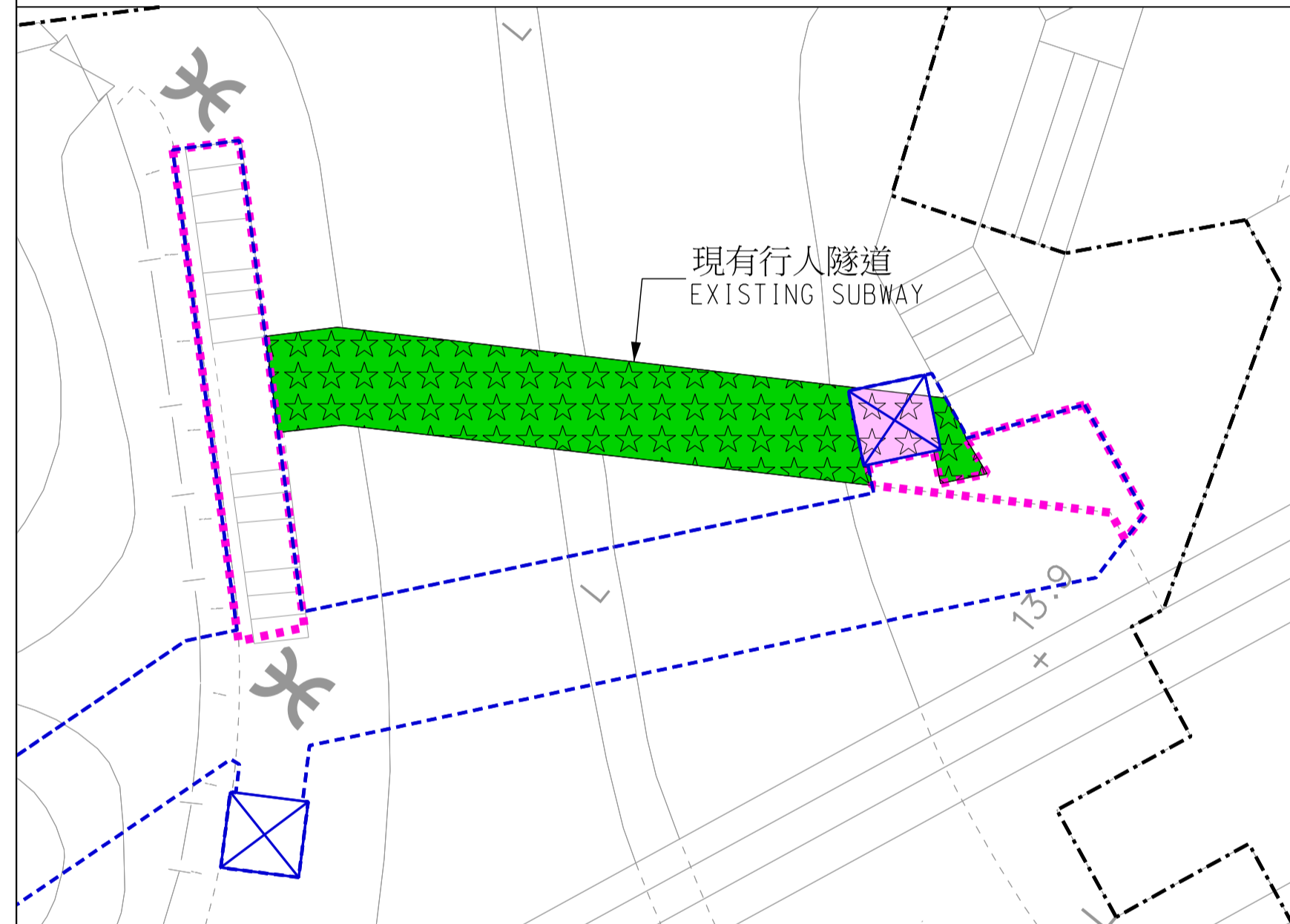
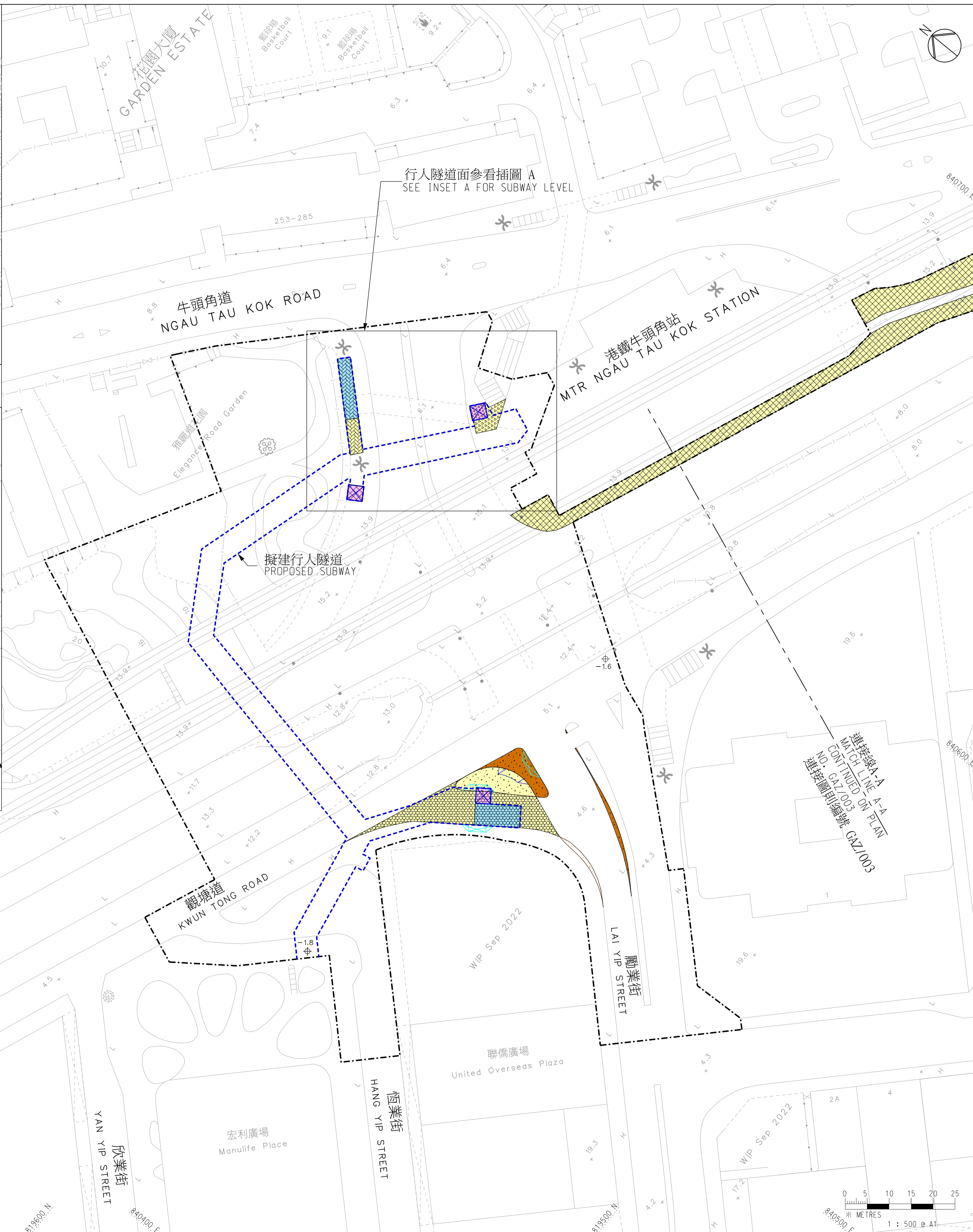
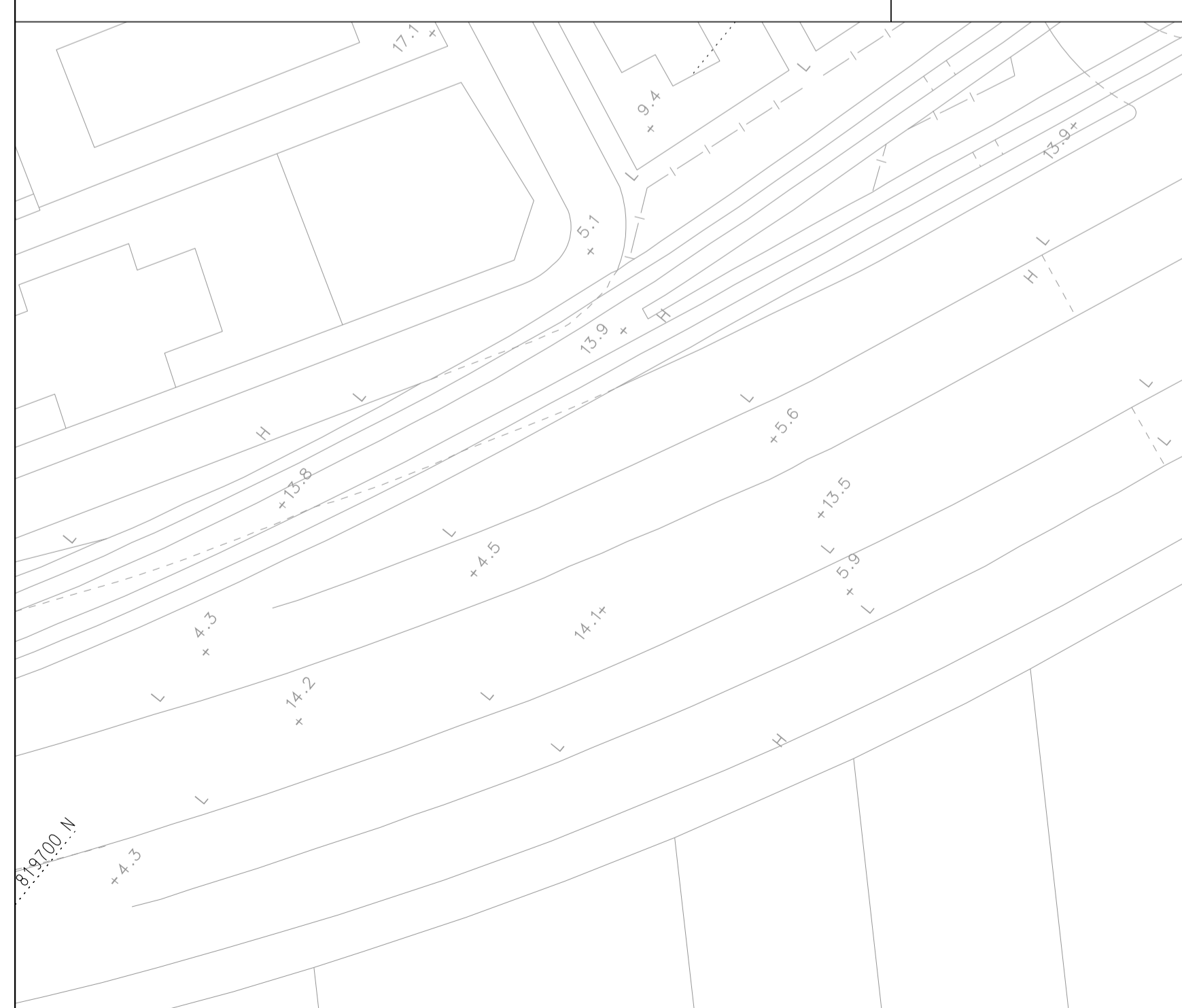

- 註釋 NOTES :
- 除另有說明外，所有量度以米為單位。
ALL DIMENSIONS ARE IN METRES UNLESS OTHERWISE SPECIFIED.
 - 所有水平均為約數，以米為單位，並在香港主水平基準以上。
ALL LEVELS ARE APPROXIMATE VALUES AND IN METRES ABOVE HONG KONG PRINCIPAL DATUM.
 - 如有需要，施工區界限內的部分現有行車道、行人路、行人隧道、美化市容地帶、休憩用地、行人隧道樓梯出入口、行人隧道坡道出入口、行人過路處和路中預留帶/安全島或會分階段暫時封閉。
SECTIONS OF THE EXISTING CARRIAGEWAYS, FOOTPATHS, SUBWAYS, AMENITY AREAS, OPEN SPACES, SUBWAY STAIRCASE ENTRANCES, SUBWAY RAMP ENTRANCES, PEDESTRIAN CROSSINGS AND CENTRAL RESERVES/TRAFFIC ISLANDS WITHIN THE LIMIT OF WORKS AREA MAY BE TEMPORARILY CLOSED IN PHASES AS AND WHEN REQUIRED.

工程名稱
PROJECT TITLE

工務計劃項目第6191TB號(部分)
擬議觀塘商貿區的行人環境改善工程 - 牛頭角範圍
PWP ITEM NO. 6191TB (PART)
PROPOSED PEDESTRIAN ENVIRONMENT IMPROVEMENT WORKS IN KWUN TONG BUSINESS AREA - NGAU TAU KOK PORTION

圖則名稱
PLAN TITLE

根據《道路(工程、使用及補償)條例》(第370章)而在憲報公布的圖則
PLAN FOR GAZETTING UNDER ROADS (WORKS, USE AND COMPENSATION) ORDINANCE (CHAPTER 370)
(三張之第一張) (SHEET 1 OF 3)

圖則編號
PLAN NO.

GAZ/002

比例
SCALE

1:500

A1

版權所有不得翻印 COPYRIGHT RESERVED

辦事處
OFFICE

工程處
WORKS DIVISION

HIGHWAYS DEPARTMENT HONG KONG
路政署
香港

