

- 一般說明 GENERAL NOTES**
- 有關一般說明參閱圖號 SCL-G01。
FOR GENERAL NOTES, REFER TO DRAWING NO. SCL-G01.
 - 收回地層的細節在圖則第SCL-U08號顯示。
DETAILS OF UNDERGROUND STRATA RESUMPTION ARE SHOWN IN DRAWING NOS. SCL-U08.
 - 收回的地層在圖則第SCL-U01至SCL-U07號中以參線的切面立視圖顯示。
UNDERGROUND STRATA TO BE RESUMED ARE SHOWN IN THE SECTIONAL ELEVATION ALONG THE REFERENCE LINE IN DRAWING NOS. SCL-U01 TO SCL-U07.
 - 沿參線的切面立視圖顯示的正/負主水平基準均為約數。
THE +/- mPDs SHOWN IN THE SECTIONAL ELEVATION ALONG REFERENCE LINE ARE APPROXIMATE.
 - 圖則顯示於可被收回的地層的任何現有公用設施將不會被收回。
ANY EXISTING UTILITIES LOCATED WITHIN THE UNDERGROUND STRATA PROPOSED TO BE RESUMED WILL NOT BE RESUMED.

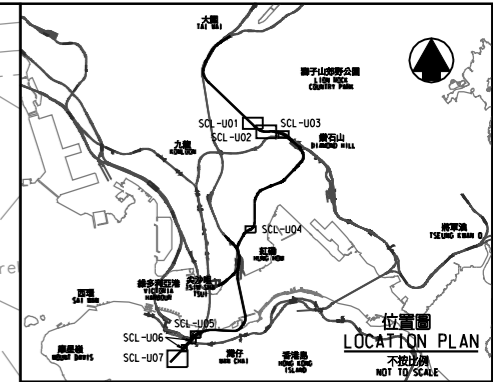
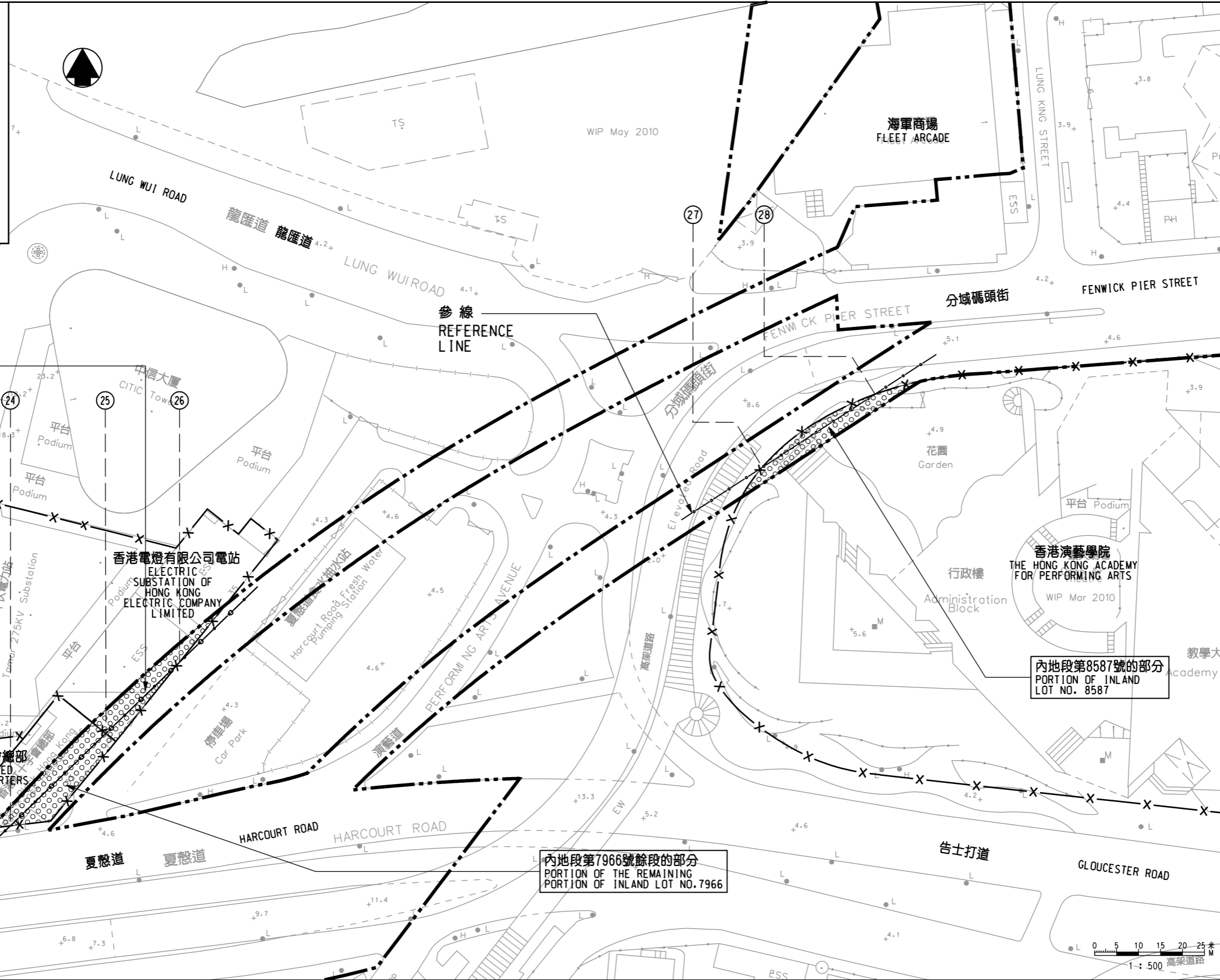

圖例 LEGEND

- 方案界線
BOUNDARY OF THE SCHEME
- 可被收回的地層
UNDERGROUND STRATA PROPOSED TO BE RESUMED
- 可被收回的地層 (在該地層內的任何現有柱及地基將不會被收回)
UNDERGROUND STRATA PROPOSED TO BE RESUMED (ANY EXISTING PILES AND FOUNDATIONS LOCATED WITHIN SUCH STRATA WILL NOT BE RESUMED)
- 擬建的鐵路車站及其他鐵路設施(地下)
PROPOSED RAILWAY STATION AND OTHER RAILWAY FACILITIES (UNDERGROUND)
- 擬建的車站/車站入口/通風大樓/通風井/其他鐵路設施或永久建築物
PROPOSED RAILWAY STATION/STATION ENTRANCES/VENTILATION BUILDINGS/VENTILATION SHAFTS/OTHER RAILWAY FACILITIES OR PERMANENT STRUCTURES
- 地段界線
LOT BOUNDARY
- 參線標記
REFERENCE LINE MARK
- 參線
REFERENCE LINE

修訂表 TABLE OF AMENDMENTS

修訂	日期	繪圖	類別	負責	說明
REV	DATE	BY	SUB	APP	DESCRIPTION

SIGNED
伍德榮 NG TAK WING
核准發出
APPROVED FOR ISSUE
10 NOV 2010
發出日期 DATE OF ISSUE
鐵路發展處副處長(1)
GOVERNMENT ENGINEER/
RAILWAY DEVELOPMENT (1)
HIGHWAYS DEPARTMENT

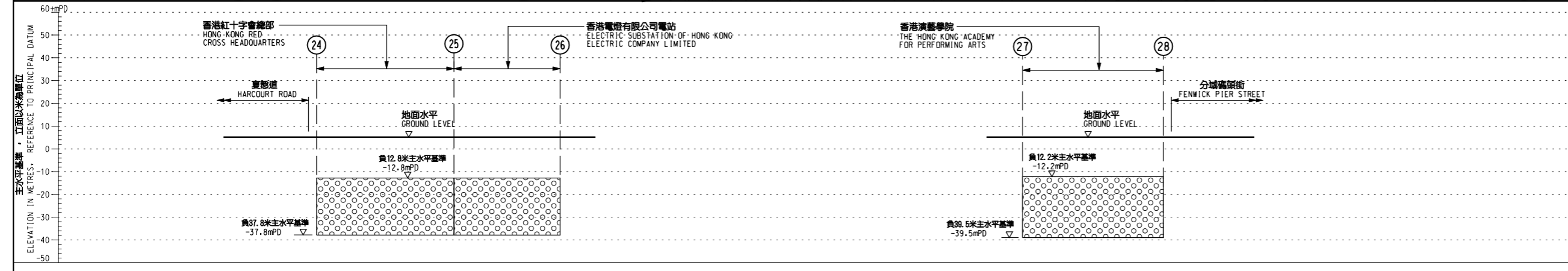

圖則名稱 DRAWING TITLE
**鐵路條例(第519章)
沙田至中環線
收回地層圖則
8頁的第5頁**

RAILWAYS ORDINANCE (CHAPTER 519)
SHATIN TO CENTRAL LINK
UNDERGROUND STRATA RESUMPTION PLAN
SHEET 5 OF 8

圖號 DRAWING NO. SCL-U05
比例 SCALE 1:500 (A1)
或如顯示
AS SHOWN

**香港特別行政區政府
THE GOVERNMENT OF THE HONG KONG
SPECIAL ADMINISTRATIVE REGION
路政署
HIGHWAYS DEPARTMENT
鐵路拓展處
RAILWAY DEVELOPMENT OFFICE**

沿參線的切面立視圖 SECTIONAL ELEVATION ALONG REFERENCE LINE 不按比例 NOT TO SCALE